

PREMIUM BOOK &  
SCHEDULE OF EVENTS  
*Our 134<sup>th</sup> Year*

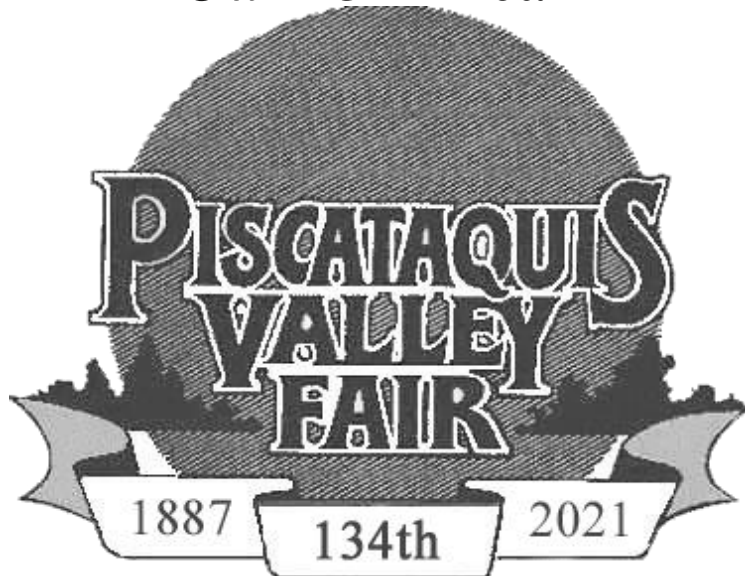

77 Fairview Ave., P O Box 197  
Dover-Foxcroft, ME 04426  
(207) 717-9100 Week of Fair Only  
[www.PiscataquisValleyFair.com](http://www.PiscataquisValleyFair.com)

**August 26 – 29, 2021**

Thursday/Friday

Midway Opens at 2:00 PM

Saturday/Sunday

Midway Opens at 11:00 AM

**Fairgrounds Open at 6:00 AM**

***A Down Home Country Fair***

**Wrist Bands:** Thursday \$15, Friday - Sunday \$17 per day

Campsites Available

**Admission:** \$8.00 each day (over 12 yrs.)

\$2.00 (5 – 12 years), under 5 – Free

**Thursday - SENIOR CITIZEN DAY - \$3.00**

***Free Parking on Grounds ~ ATV's always welcome with  
direct access to fairgrounds through Gate #3***

DRINKING in public is against State Law

NO DOGS ALLOWED ON GROUNDS (Service Dogs  
Excepted)

**Remember to use our wash stations after visiting the  
animals**



# 2021 SCHEDULE OF EVENTS

## THURSDAY, AUGUST 26<sup>th</sup>

8:00 AM ..... Open Ox Weigh-in  
 10:00 AM ..... Open Flower Judging  
 12:00 Noon ..... Fire Dept. Museum Opens  
 12:00 Noon ..... Exhibition Halls Opens  
 12:00 Noon ..... Animal Land Opens  
 12:00 Noon ..... Open Ox Pulls  
 2:00 PM ..... Midway Rides Open  
 3:00 PM ..... Frisbee Toss behind Ice Cream Parlor  
 4:00 PM ..... Pedal Tractor Pull at the Milking Parlor  
 4:00 PM ..... Bingo  
 5:30 PM ..... Bicycle Drawing at the Fair Office  
 5:30 PM ..... Milking Demonstration in Milking Parlor  
 6:00 - 9:00 PM ..... Midnight Rose on the Stage  
 6:00 PM ..... Figure 8 Race at the Mechanical Track  
 6:00 PM ..... 50/50 Raffle During Figure 8 Race  
 7:30 PM ..... He-Man Contest  
 9:00 PM ..... Fireworks

## FRIDAY, AUGUST 27<sup>th</sup>

9:00 AM ..... Farmers Horse Weigh-in  
 10:30 AM ..... Youth Dairy Show  
 12 Noon - 8 PM ..... Fire Dept. Museum Opens  
 12:00 Noon ..... Exhibition Halls Opens  
 12:00 Noon ..... Animal Land Opens  
 12:00 Noon ..... Bingo  
 12 - 1:30 PM ..... Fireman Fred on the Gazebo  
 1:00 PM ..... Farmers Horse Events  
 1:30 - 3PM ..... Kevin Hamel on the Gazebo  
 2:00 PM ..... Midway opens  
 3:00 PM ..... Relay Race behind Ice Cream Parlor  
 3 - 4:30 PM ..... Ritchie K on the Gazebo  
 4:30 PM ..... Pedal Tractor Pull at Milking Parlor  
 5:30 PM ..... Bicycle Drawing at Fair Office  
 5:30 - 7 PM ..... Riff Johnson on the Stage  
 5:30 PM ..... Milking Demonstration in Milking Parlor  
 6:00 PM ..... Tuff Truck at Mechanical Track  
 6:00 PM ..... 50/50 Raffle during Tuff Truck  
 7:00 - 8 PM ..... Horse Pulling Weigh-in  
 7:30 - 10 PM ..... Fire + Ice on the Stage

## SATURDAY, AUGUST 28<sup>th</sup>

6:00 AM ..... Horse Pulling Weigh-in  
 8:30 AM ..... Fun Horse Show  
 10:00 AM ..... Farm Tractor Pulls at Mechanical Track  
 10:00 AM ..... 50/50 Raffle during Farm Tractor Pulls  
 10:00 AM - 2 PM ..... Antique Auto Display  
 10:00 AM ..... Exhibition Halls Open  
 10:00 AM - 8 PM ..... Fire Dept. Museum  
 10:00 AM ..... Horse Pulling  
 10:00 AM ..... Animal Land Opens

10:00 AM ..... Miss Maple Pageant on the Stage  
 10:00 AM - 12 Noon ..... Cookie Decorating on the hill  
 10:00 AM ..... Horseshoe Tournament behind dining hall  
 10:30 AM ..... Youth Beef Cattle Show  
 11:00 AM ..... Conjuring Carol  
 11:00 AM ..... Midway Rides Open  
 11:30 AM ..... Skillet Throw - Sign up at Fair Office  
 12:00 Noon ..... Bingo  
 12 - 1:30 PM ..... Fireman Fred on the Gazebo  
 1:00 PM ..... Pedal Tractor Pulls at Milking Parlor  
 1:00 PM ..... Frog Jumping Contest  
 1:30 - 3 PM ..... Craig Stutzman on the Gazebo  
 3:00 PM ..... Animal Costume Parade  
 3 - 4:30 PM ..... Michelle Boone on the Gazebo  
 4:00 PM ..... Conjuring Carol  
 4:00 PM ..... Bicycle Drawing at the Fair Office  
 4:30 PM ..... Three Legged Race behind Ice Cream Parlor  
 5:30 PM ..... Milking Demonstration in Milking Parlor  
 6:00 PM ..... Truck Pulls at Mechanical Track  
 6:00 PM ..... 50/50 Raffle during Truck Pulls  
 6:00 PM Wrist Wrestling-Sign up, 5:30 pm the Police Bldg  
 7:30 - 10 PM Sharon Hood- Dixon Road Band on the Stage

## SUNDAY, AUGUST 29<sup>th</sup>

6:00 AM ..... Horse Pulling Weigh-in  
 9:00 AM ..... Game Horse Show  
 9:00 AM ..... Garden Tractor Pulls at Mechanical Track  
 9:30 AM ..... Horse Pulling  
 10:00 AM ..... Conjuring Carol  
 10:00 AM ..... Doodlebug Draw at Mechanical Track  
 10:00 AM ..... Exhibition Halls Open  
 10:00 AM ..... Fire Dept. Museum Opens  
 10:00 AM - 12 Noon .... Pig Scramble sign-up at Fair Office  
 10:00 AM ..... Animal Land Opens  
 10:00 AM ..... Pedal Tractor Pull Off at Milking Parlor  
**Must place 1st, 2nd, or 3rd during one of the regular pedal tractor pulls to qualify**  
 10:00 AM ..... Horseshoe Tournament behind dining hall  
 10:30 AM ..... Youth Dairy Goat Show  
 10:30 AM ..... Pie Judging  
 11:00 AM ..... Midway Rides Opens  
 11:30 AM ..... Wheel Barrel Race behind Ice Cream Parlor  
 12:00 Noon ..... Bingo  
 12 - 1 PM ..... Chris Flaherty on the Gazebo  
 1:00 PM ..... Pig Scramble at Pulling Area  
 3:00 PM ..... Demolition Derby-including pro-modified  
 3:00 PM ..... 50/50 Raffle during Demolition Derby  
 3:00 PM ..... Power Wheel's Demo Derby during regular Demo Derby  
 4:00 PM ..... Conjuring Carol  
 4:00 PM ..... Bicycle Drawing at the Fair Office  
 6:00 PM ..... Fair Closes

# PISCATAQUIS VALLEY FAIR ASSOCIATION

## OFFICERS

PRESIDENT: Rusty Weymouth ..... 694-0192  
VICE PRESIDENT: Josh Campbell ..... 852-7631  
SECRETARY: Donna Weymouth ..... 745-5778  
TREASURER: Scott Taylor ..... 564-7738

## DIRECTORS

Brian Westman, Deanne Merrill, Jason Weston,  
Jasmane Hanson, Keshia Flint, Ronnie Simpson,  
Steve Saunders, Dan Bishop, Joe Guyotte,  
and Past President Donnie Merrill

## CONTACT INFORMATION

**Food & Produce:** Denise Tirrell.....717-8119  
Wed., Aug. 25<sup>th</sup>, 4 pm - 8 pm at Exhibition Hall #1

**Family Game Show:** Amanda Sherburne      [www.dexterridingclub.com](http://www.dexterridingclub.com)

**Flower Show:** Darlene Durgin.....

**Livestock:** Ron Simpson, Supt. ....270-1212  
Wed., Aug. 25<sup>th</sup>, 4 pm - 8 pm. Hall #1

**Horse Pulling:** Karna Johnson, Supt. ....343-4355

**Central ME Sheep Breeders:** Kim Morris, Pres. ....943-5098

**Home Arts & Crafts:** Tracy Redmond .....564-3088  
Tues., Aug. 24<sup>th</sup>, 2 pm - 7 pm Exhibition Hall #1

**4-H Exhibits:** SheilaNorman.564-3301 [Sheila.Norman@maine.edu](mailto:Sheila.Norman@maine.edu)

**Youth Sheep Show:** Kim Morris .....943-5098

**Fun Horse Show:** Angie Clukey .....852-0831

**Mechanical Track:** Josh Campbell, Supt. .... 852-7631  
Dan Bishop .....343-1975 [dtreport@myottmail.com](mailto:dtreport@myottmail.com)  
RustyWeymouth .....694-0192  
Trey Weymouth .....907-0487

**Farm Horse Events:** Karna Johnson, Supt.....343-4355

---

More Information available on the web:

[www.PiscataquisValleyFair.com](http://www.PiscataquisValleyFair.com)

Or find us on Facebook

## Thank you to this year's sponsors:

A E Robinson  
C & J Variety Sport Shop  
Dean Rideout & Sons Trucking  
Dover True Value Hardware  
Gerald Thomas, Including  
H.A. Higgins & Son  
Harris Lumber, LLC  
JD Brawn, Inc  
Johnson Foundations  
Lovell's Hardware  
Pat's Dairyland  
Pleasant River Lumber  
Rowell's Garage  
SM Earthworks  
Three Rivers Feed, LLC  
Tilton's Auction  
Tractor Supply  
Trade Winds Marketplace, Milo  
Trashbusters  
Trask Insurance  
W.W London Woodlot Management Co  
Whitney's Family Super Market  
William W. London & Son, Inc  
Will's Shop 'n Save

### Andrew Libby Memorial Pull Sponsors:

Bailey Construction  
Dave Fish  
Glidden Lumber  
Head to Tails Family Pet Store  
J & J Farm  
Maine Timber Mats LLC  
Mark Tolman  
Milo Chip LLC  
Naughty Dog Obedience  
Scott's Recreation - Orono  
Tilton's Auction

### TUFF TRUCK sponsors:

All Time Towing & Recovery  
Elite Auto Carriers

## GENERAL ADMISSION

The gates will open each day of the fair at 6:00 AM. Midway opens Thursday & Friday 2 PM-closing, Saturday & Sunday 11 AM-closing. General Admission \$8.00 per person per day, children 5 to 12 yrs. of age are \$2.00 per person per day, children under 5 are FREE. Senior Citizen day is Thursday, August 27th. Anyone 65 years of age or older will be admitted for half price. Proof of age is required. Every day is a Wrist Band day. Purchase Wrist Band on the midway.

## ONLY SERVICE ANIMALS ALLOWED ON THE FAIRGROUNDS.

Show animals allowed in specified areas. Campers must keep pets in the campground. Horse and Livestock trailers must be parked in back parking lot.

More information is available at  
[www.PiscataquisValleyFair.com](http://www.PiscataquisValleyFair.com)

Find us on Facebook



## EXPRESSION OF APPRECIATION

The Fair thanks all the exhibitors, Piscataquis Sheriff's Department, Dover-Foxcroft Fire Department, Mayo Regional Hospital, Central Maine Power, ticket takers, Town's people, Community Fitness, and anyone else who helps to make our Fair successful. Without **YOU** there would be no fair.

## FIRST AID

*Darcy Merrill R.N., Supt.* - A First Aid station sponsored by Mayo Regional Hospital will be open on the Fairgrounds during Fair Hours.

## CAMPING ON GROUNDS

*Campground Superintendents: Fred Frye* - All campers must enter through Gate 2, Campsites are on a first come first serve basis, \$20.00 per day which includes 15 amp electrical hookup and water. All campers must have a back flow valve. Payment made when you enter the fairgrounds along with your daily entrance fees for all in your party through Sunday. If you choose to leave early a refund will be given at the time that you leave. Campers will be billed for every night that they are on the grounds, whether they are hooked up or not. It is not the responsibility of the campground officials to ask other campers to move so that you can get out, pick your site wisely. Livestock and fair association members should contact the superintendent of their area before arrival on the grounds to get their camping pass.

## GROUNDS RENTAL

*Jasmane Hanson 735-6055 or Trisha White 717-7619* - Grounds rental shall be \$16.00 per front foot, minimum of 10'. Inside space is \$100 single, \$180 double space. Payment is due before setup.

## DINING HALL RENTAL

*Deanne Merrill 943-2650* - The Fairgrounds Dining Hall is available for rental during the year. Please call for information, rates, and available dates.

## PREMIUMS & COMPETITION

The Directors of the Piscataquis Valley Fair Association reserve the right to withhold payment of any and all premiums until after the completion of the Fair, at which time premiums will be mailed to recipients. The right is also reserved to reduce premiums in the event of inclement weather and/or unforeseen circumstances that greatly impact the income received during the four days of the Fair.

*Disclaimer: The Piscataquis Valley Fair disclaims any liability for loss or damage to exhibits or personal property of exhibitors.*

## FOOD AT THE FAIR

*Please use our wash stations before purchasing or consuming food.*

### FAIR FOOD BOOTH

(On the hill, overlooking the pulling area) Breakfast – Thursday, August 26<sup>th</sup> from 7 AM to 11 AM. Friday, Saturday, and Sunday, August 27<sup>th</sup>-August 29<sup>th</sup> from 6 AM to 11 AM: Coffee, Juice, full breakfast - eggs, bacon, sausage, home fries. Lunch & Dinner - 11 AM to 10 PM: Burgers, hotdogs, sausage, fries, chicken fingers, homemade pies, water and soda.

### ICE CREAM PARLOR

(Beside the Milking Parlor) Gifford's Ice Cream. Cones, Shakes, Floats, Sundaes, Lots of flavors. Water and soda.

*Many more Food Vendors will be serving your fair favorites.*

**The Piscataquis Valley Fair (PVF) will provide care and protection of all exhibits. However, PVF distinctly disclaims any liability for loss or damage to exhibits or personal property.** This year's competitions have been updated. The structure and premiums have been modified to be closer to competitions at other Fairs. The Fair Flyer now provides information about completions.

# EVENTS

## BICYCLE DRAWING

Entry blanks available at the Fair Office. Children ages 5 to 14 years may enter. Pepsi provides 4 bicycles for the drawing. The drawings will be held on Thursday and Friday at 5:30 PM and Saturday and Sunday at 4 PM must be present to win. A person can only win once a year.

## BINGO

*Sangerville Fire Department, Jeff Willey 876-3438*

**Thursday, August 26<sup>th</sup> @ 4:00 PM**

**Friday – Sunday, August 27<sup>th</sup> – 29<sup>th</sup> starting at NOON**

The Sangerville Fire Department will provide Bingo starting Thursday. Cover-All games. Friday 7 PM cover card in 55 numbers or less wins \$200 jackpot (more than 55 numbers gets \$50). Saturday 6 PM cover card in 56 numbers or less gets \$200 jackpot (more than 56 numbers get \$50). Sunday 2 PM jackpot with play until there's a winner.

## PEDAL TRACTOR PULL (In Front of Ice Cream Parlor)

*Rusty & Donna Weymouth 694-0192 or 745-5778*

**Thursday, August 26<sup>th</sup> at 4:00 PM**

**Friday, August 27<sup>th</sup> at 4:30 PM**

**Saturday, August 28<sup>th</sup> at 1:00 PM**

**Sunday, August 29<sup>th</sup> at 10:00 AM, Pull-Off for all prior**

**winners** Tractor and drag provided by Fair.

Weight classes are 30-40 lbs., 41-50 lbs., 51-60 lbs.

1. Open to all kids in their proper weight class.
2. Kids placing first, second, or third in their weight class during the regular pulls are eligible for the Pull-Off on Sunday.
3. Ribbons will be given for the regular pulls. Trophies to be awarded for Sunday's Pull-Off.

All decisions of the judges will be considered impartial and final. SUNDAY'S PULL-OFF is for WINNERS from the first three days. NO new participants at Pull-Off.



## HE-MAN CONTEST

*Dan Bishop 564-7700 or Billy Smart 564-7712*

**Thursday, August 26<sup>th</sup> at 7:30 PM in the Horse Pulling Ring**

Tugging Lifting, Throwing – timed event. Classes for both men and women. The ultimate endurance test. Everyone is welcome to participate. Bring your family and friends.

## FIRE DEPARTMENT MUSEUM

**Thursday & Friday, Noon to 8 PM; Saturday & Sunday. 10 AM to 8 PM**

Dover-Foxcroft Fire Department (Located next to Police Building) Come see firefighting equipment from the late 1800's to present day.

## FROG JUMPING CONTEST

*Gary Sudsbury 564-2931*

**Saturday, August 28<sup>th</sup> at 1:00 PM at the Baseball Field**

The ONLY RULES: Just pretend you are twelve again and have fun (except for those under twelve who already know how). Bring your own frog or you may use one supplied by the Fair. Trophies will be awarded in each of the following groups: Age 8 and under, 9-13, 14-18, and parent class.



## **BOB'S SUGARHOUSE**

***Bob & Barb Moore 564-2145***

Bob's Sugarhouse is located by the Fair Food Booth. Plan to drop by for Barbara's homemade fudge and maple sugar candy. Swap stories of good old days when sap was collected by horse and wagon and boiling down meant around-the-clock over a hot wood fire and a homemade boiling pan.

## **PIG SCRAMBLE**

***Karna Johnson – 343-4355***

**Sunday, August 29<sup>th</sup> at 1:00 PM at the Pulling Ring**

Sign-up: 10 AM to Noon Sunday at the fair office. \$2 entry fee. Exciting event. Rules for the Pig Scramble: Participants must be between the ages of 6 and 12. (Three age groups: 6-8 years, 9-10 years, 11-12 years) Must have filled out parental permission slip. NOT EVERY CHILD THAT SIGNED UP WILL BE PICKED. NOT EVERY CHILD THAT GETS PICKED WILL CATCH A PIG. Names will be drawn at the start of each age group

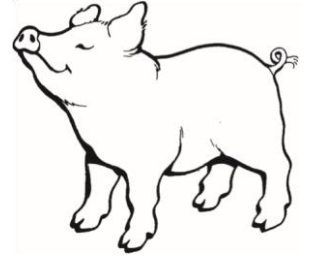

## **LADIES SKILLET THROW**

***Karna Johnson – 343-4355***

**Saturday, August 28<sup>th</sup> at 11:30 AM in the Horse Pulling Ring**

Ladies need to register by 11:30 AM. Forms may be picked up at the Fair Office any time during the Fair. Age Groups: 18-35: 1st \$30, 2nd \$20, 3rd \$10; 36-49: 1st \$30, 2nd \$20, 3rd \$10; 50-64: 1st \$30, 2nd \$20, 3rd \$10; 65 & over: 1st \$30, 2nd \$20, 3rd \$10. Winners of their age group will throw for overall ribbon.

## **WRIST WRESTLING**

***Gary Sudsbury 564-2931***

**Saturday, August 28<sup>th</sup> at 6 PM**

Signup 5:30 PM by Police Building.

Eliminations trials run until a winner is decided in each weight class. Trials are for both men and women going by weight. USA Armsports Rules and Regulations will apply. Intoxication, alcohol consumption or unruly behavior or language is prohibited. Find the rules on the website.



# ENTERTAINMENT



## STAGE -

### ◆Midnight Rose

Thursday, August 26<sup>th</sup> 6:00 PM - 9:00 PM

### ◆Riff Johnson

Friday, August 27<sup>th</sup> 5:30 PM - 7:00 PM

### ◆Fire + Ice

Friday, August 27<sup>th</sup> 7:30 PM - 10:00 PM

### ◆Sharon Hood-Dixon Road Band

Saturday, August 28<sup>th</sup> 7:30 PM - 10:00 PM

## GAZEBO -

### ◆Fireman Fred -

Friday, August 27<sup>th</sup> 12 noon - 1:30 PM

Saturday, August 28<sup>th</sup> 12 noon - 1:30 PM

### ◆Kevin Hamel -

Friday, August 27<sup>th</sup> 1:30 PM - 3:00 PM

### ◆Riff Johnson -

Friday, August 27<sup>th</sup> 3:00 PM - 4:30 PM

### ◆Craig Stutzman -

Saturday, August 28<sup>th</sup> 1:30 PM - 3:00 PM

### ◆Michelle Boone -

Saturday, August 28<sup>th</sup> 3:00 PM - 4:30 PM

### ◆Chris Flaherty-

Sunday, August 29<sup>th</sup> 12:00 PM – 1:00 PM

**Fireman Fred will be around the  
Fairgrounds Thursday - Sunday**

**Conjuring Carol will be on the hill by the fair  
office on**

Saturday August 28<sup>th</sup> at 11:00 AM & 5 PM

Sunday August 29<sup>th</sup> at 10:00 AM & 4 PM



## FLOWER SHOW, HOME ARTS & CRAFTS, FOOD & PRODUCE

*Disclaimer: The Piscataquis Valley Fair (PVF) will provide care and protection of all exhibits. However, PVF distinctly disclaims any liability for loss or damage to exhibits or personal property. This year's competitions have been updated. The structure and premiums have been modified to be closer to competitions at other Fairs. The Fair Flyer now provides information about competitions.*

### FLOWER SHOW

**Darlene Durgin -**

Located in Exhibition Hall #1.

Bring flowers Wednesday, August 25<sup>th</sup> 4-8 PM. Sunday pickup times 4-5 PM.

Premiums - Adult: 1st \$6, 2nd \$4, 3rd \$2

Youth: 1st \$3, 2nd \$2, 3rd \$1

Only one entry per category per person is allowed.

Categories: Fresh Flower Arrangements, Flowering Plants, Foliage Plants, Specimens: (Cut Flowers, 1 stem per container – containers provided). Judging at 10 am on Thursday. Best of Show for Flower Arrangement ONLY.



### HOME ARTS AND CRAFTS

**Tracy and Nan Redmond 564-3088** RULES and REGULATIONS:

Only one entry per category per person is allowed.

**All entries must be made by the person offering them for exhibit.**

1. Please provide a list of your articles with your name, address, and phone number. If you made something that does not fit our categories, we will attempt to find a place for it.
2. Judging will be determined on general appearance, design, workmanship, age of exhibitor and usefulness of article.
3. All handywork must have been completed within the fair year (August 2020 – August 2021)
4. Enter articles between 2 and 7 PM Wednesday, August 25<sup>th</sup> at Exhibition Hall #1 at the Fairgrounds.
5. Articles must be picked up Sunday, August 29<sup>th</sup> after 5 PM. **ANY ITEM PICKED UP PRIOR TO 5 PM ON SUNDAY WILL FORFEIT THEIR PREMIUMS.**
6. We reserve the right to reject any article that is unfinished, soiled, ripped or damaged or not in keeping with the above-listed rules and regulations. We reserve the right to limit the number of items submitted by individuals or families.



Categories are: Afghans, bedspreads, lap robes, centerpieces, doilies, pillows, vests, quilts, baby items, sweaters, mittens, socks, macramé, wall hangings, Christmas items, dolls, toys, plastic canvas, hooked & braided rugs, chair seats, baskets, jewelry, candles, paintings, photographs (still life, nature, animals, people); must be framed to protect them from dust in the Exhibition Hall), tablecloths, napkins, and place mats.

Premiums: 1st \$10, 2nd \$8, 3rd \$5. Youth: 1st \$3, 2nd \$2, 3rd \$1. Judges Choice – Adult \$25 – Youth \$10

### FOOD AND PRODUCE

**Denise Tirrell 717-8119**

Includes fresh produce, canned goods, and specified baked goods.

## 2019 FOOD & PRODUCE SCHEDULE SUMMARY

Wednesday	4 pm – 8 pm	Bring entries for foods, produce & muffins to Exhibition Hall #1
Thursday	10:00 am	Judging for food & produce
	Noon	Fair Opens
Saturday	10 am - Noon	Cookie Decorating at dining hall
Sunday	8 am - 10 am	Bring Apple Pies to Exhibit. Hall #1
	10:30 am	Pie Judging
	5 - 6 pm	Pick up prize money-Exhibit. Hall #1
	5 - 6 pm	Pick up items

## PRODUCE

### *Denise Tirrell 279-1980*

Only one entry per category per person is allowed. **Rules [www.PiscataquisValleyFair.com](http://www.PiscataquisValleyFair.com)**

**Categories:** Vegetables – Beans, Snap & Pole (10), Onions (3)-braided tops for hanging 2 varieties, BeansDry (Jacob, Yellow eye, Pea, other) & Shell (1cup) 1 variety, Parsnips (3), Beets (3) Early Wonder, Detroit, Red Ball, Peas (10 pods) snow, sugar snaps, other, Broccoli (1), Peppers (3) Green, Red, Yellow, Jalapeño, Brussell Sprouts (10), Potatoes (3) 6 varieties, Cabbage (1), Pumpkin (1), Carrots (3), Radishes (3), Cauliflower (1), Squash-summer (1) & winter (1), Corn (3), Decorative corn (3 braided), Cucumbers (3), Tomatoes (3), Cherry Tomatoes (1 pint), Gourds (1), Greens (bunch) 3 varieties, Turnips (1), Lettuce (1 head), Zucchini.

Berries & Fruits: Applies (3), Blackberries (1 pint), Blueberries (1 pint), Cherries (1 pint), Grapes (1 bunch), Pears (3), Raspberries (1 pint). Cover pints of berries with clear plastic wrap to prevent fruit flies.

**Premiums:** Adult: 1st - \$8 / 2nd - \$6 / 3rd - \$3. Youth: 1st - \$3 / 2nd - \$2 / 3rd - \$1.

## HOME CANNED FOODS

Adults and Youth (16 and under)

**Categories C1 – C4:** 1st \$6, 2nd \$4, 3rd \$2 plus Ribbons.

Must be canned by exhibitor within 1 year. **Jars must be labeled on side with product name, date processed, processing method and processing time.** Minimum of two (2) varieties in each category.

Category	Description	Category	Description
C1	Fruits	C3	Pickled Foods
C2	Vegetables	C4	Soft Spreads (Jams & Jellies)

## COOKIE DECORATING

### *Marsha Young 285-3656*

**Saturday, August 28<sup>th</sup> 10AM-Noon under the tent on the hill.**

Kids Cookie Decorating. Cookies and decorating supplies provided by Piscataquis Valley Fair Assoc.

## BREADS, BISCUITS, ROLLS & MUFFINS

Junior and Adult Divisions 1st \$8, 2nd \$6, 3rd \$5 Judge's Choice \$25

Sweet breads & yeast breads – ½ loaf

Biscuits, rolls, & muffins - Enter THREE (3) Muffins on a disposable plate. Cover food w/ plastic wrap. All baked goods are tasted. Must be accompanied by the recipe printed on a 4 x 6 inch card. Will be judged on appearance, texture, and taste. Entries will not be returned.

## BERRY PIE CONTEST

Submit pies on Sunday, August 29<sup>th</sup>, from 8-10 AM at Exhibition Hall #1. Judging at 10:30 am

Premiums: (3 prizes) \$20, \$15, \$10 plus ribbons. Judges Choice: \$25

Open to all pie bakers. Bring the recipe printed on a 4 x 6 card. Please submit ONE PIE ONLY for judging. Bake the pie the day before. Warm pies cannot be judged properly. Judged on ease of preparation, texture, flavor, and overall appearance. Use a disposable pan.

## **MILKING PARLOR**

Piscataquis Valley Fair is proud to present our new milking parlor built in 2011. It sports an inside walkway for better viewing of the daily milking demonstrations (6PM Thursday, Friday and Saturday) and an extensive display of Maine milk bottles and antique milking equipment.

## **GRANGE EXHIBITS**

**Bill Bemis 924-3537** Exhibition Hall #1

Open to any Grange. Display to include a variety of products raised or made by members of each organization. Each display will be placed in an area approx. 10'. Judged by Maine State Grange "Judging Guidelines for Grange Fair Exhibits".

## **4-H ANIMAL LAND**

**Ron/Brenda Oldfield 717-8806, Geneva Libby**

Please use our wash stations after visiting the animals. Hours: Thursday – Saturday 9 AM to 7 PM. Sunday 9 AM to 5 PM Open to any 4-H, FFA, or Youth Livestock owner to display their animal projects. All owners are responsible for the care and feeding of their livestock. All animals must be free of disease and in good health. Proof of good health can be a veterinarian record sheet or health certificate. A schedule will be posted at Animal Land and the Fair Office. Reminder to all visitors of Animal Land: the animals are not in their usual homes so they can bite. Please keep young children safe. Final check-in for all animals to be displayed will be Thursday morning at 10 AM. Ribbons and premiums are awarded according to the Danish System to all 4-H, FFA participants in Animal Land. All other participants will receive participation ribbons.

## **4-H PEOPLES CHOICE AWARD**

The public will judge 4-H Club Exhibits for Peoples Choice Award from Thursday - Saturday and a small prize may be awarded on Sunday for the winning exhibit.

## **4-H YOUTH EXHIBIT RULES**

**Sheila Norman 564-3301 or email at "Sheila.Norman@maine.edu"**

1. Entries are open to 4-H members in Piscataquis, Somerset and Penobscot Counties who are carrying on approved 4-H projects. 2. Entries must be from current 4-H projects 2020-2021 4-H year. Exhibits will be judged by the Danish system and will be placed in three groups, BLUE-1st, RED-2nd, and WHITE-3rd. Each qualifying exhibit will be awarded a ribbon and premium. All clover buds (5 to 8 yrs.) will receive a green ribbon and honorarium. All exhibits must be brought to the Exhibition Hall at the fairgrounds on Tuesday, August 24th from 3-5 PM. They must be removed from the 4-H Exhibit Hall on Sunday, August 29th from 4-5 PM. 3. For more information go to: <https://extension.umaine.edu/piscataquis/4-h/>

## **4-H CLUB EXHIBIT**

**Sheila Norman 564-3301 or email at "Sheila.Norman@maine.edu"**

4-H clubs in Piscataquis, Penobscot, & Somerset counties are eligible to enter a club exhibit. Exhibits MUST be prepared by the youth members. Contact Sheila at the Extension Office August 21st if your club plans on having a club exhibit. 4-H club exhibits must be set up between 3 PM & 5 PM on August 25th and picked up between 4 PM and 5 PM on August 29th. For more information go to: <https://extension.umaine.edu/piscataquis/>

## **4-H SILENT AUCTION FOR**

## PISCATAQUIS 4-H LEADERS ASSOCIATION SCHOLARSHIP FUND

**August 23rd, 24th, and 25th**

The Piscataquis County 4-H Leaders' Association is holding a silent auction to raise money for a scholarship fund for 4\_H youth in Piscataquis County. The money will help with expenses related to in-state and national 4-H camps, trips, and events. Items donated by local crafters and businesses will be available for bidding on Friday, August 22<sup>nd</sup> from 1PM to 9PM and Saturday, August 23<sup>rd</sup> from 10:30AM to 9PM in the 4-H Exhibit Hall (Bell building).

*Stop by and make a bid to support 4-H Youth in Piscataquis County!*

## PISCATAQUIS VALLEY FAIR FUN HORSE SHOW

**Organized by FOXCROFT PONY CLUB**

*Angie Clukey - 207-852-0831 or dtreport@myottmail.com ~ Judge, Ivy Rosco*

**Saturday, August 28<sup>th</sup>** Start Time 8:30 AM

ENTRY FEES: \$5 per class or \$30 for the day. Fair admission of 5 and under free, 5-10 years \$2 and 10 and over \$6 will be paid at the gait, but will be deducted from your entry fee. Checks made to Foxcroft Pony Club. Current Negative Coggins and Rabies Vaccination certificates required. All open classes are W/T/C You cannot enter both Classes 4 and 5, you must enter just one.

**CLASSES MAY BE COMBINED IF LOW ENTRIES BUT JUDGED SEPARATELY.**

RIDER AGE GROUPS: 12 & Under ~ Junior 13 through 17 ~ Senior 18 & Over

\*\*\* PRIZE CLASSES: Prizes will be displayed at registration. \*\*\*

**IA. Trail Class - Open 9:00 - 11:00 AM -**

\*\*\*BREAK\*\*\*

**Open CLASS LIST:**

- |   |  |
|---|--|
| 1. Showmanship 12 & under                             | 12. Costume Class - <b>Open</b>                        |
| 2. Showmanship Jr.                                    | 13. W/T 18" Cross rails                                |
| 3. Showmanship Sr.                                    | 14. Equitation Over Fences 18"                         |
| 4. <b>PRIZE Western Halter Stakes - Open</b>          | 15. Equitation Over Fences 2'                          |
| 5. <b>PRIZE English Horse in Hand - Open</b>          | 16. Equitation Over Fences 2'6"                        |
| 6. <b>W/T English Equitation</b>                      | 17. <b>PRIZE Gambler's Choice W/T/C - All ages</b>     |
| A. 12 & Under   | 18. Command Class W/T/C -All ages                      |
| B. Junior.  | 19. Bare Back Equitation                               |
| C. Senior   | 20. W/T Western Equitation                             |
| 7. English Equitation                                 | A. 12 & Under  |
| A. 12 & Under   | B. Junior  |
| B. Junior.  | C. Senior  |
| C. Senior   | 21. Western Equitation                                 |
| 8. W/T English Pleasure                               | A. 12 & Under  |
| A. 12 & under   | B. Junior  |
| B. Junior   | C. Senior  |
| C. Senior   | 22. W/T Western Pleasure                               |
| 9. <b>PRIZE W/T English Pleasure Stakes -All ages</b> | A. 12 & Under  |
| 10. <b>English Pleasure</b>                           | B. Junior  |
| A. 12 & under   | C. Senior  |
| B. Junior   | 23. <b>PRIZE W/T Western Pleasure Stakes -All ages</b> |
| C. Senior   | 24. Western Pleasure                                   |
| 11. <b>PRIZE English Pleasure Stakes -All ages</b>    | A. 12 & Under  |
| <b>Leadline - 7 and under</b>                         | B. Junior  |
| A. Equitation   | C. Senior  |
| B. Pleasure   | 25. <b>PRIZE Western Pleasure Stakes -All ages</b>     |
|   | 26. Rescue Ralph - <b>Open</b>                         |
|   | 27. Carrot Race - <b>Open</b>                          |

28. Sack Race - **Open**  
29. Groom's Class - **entries must not have ridden in any other class!**

**Classes pointed for day-end awards for each age group: W/T, W/T/C and open divisions: W/T 12 & Under -1, 6A, 8A, 9, 13, 20A, 22A  
W/T Jr - 2, 6B, 8B, 9, 13, 20B, 22B  
W/T Sr - 3, 6C, 8C, 9, 13, 20C, 22C  
W/T/C - 12 & Under -1, 4, 5, 6A, 11, (14, 15 or 16) 17, 18, 21A, 24A  
W/T/C Jr - 2, 6B, 10B, 11, (14, 15 or 16) 17, 18, 21B, 24B  
W/T/C Sr - 3, 6C, 10C, 11, (14, 15 or 16) 17, 18, 21C.**

24C  
**Open - 1A, 4, 5, 12, 26, 28, 29**

**Riders and spectators are entering premises at their own risk. PVF or any of its members/agents shall not be liable for claims or damages arising out of injury to any person, horse or damage to any property.**

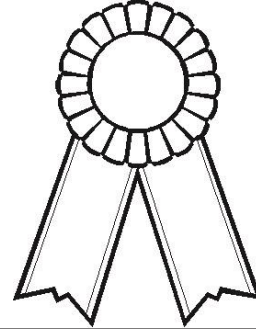

***Improper conduct towards animals or people will not be tolerated.  
Offenders may be asked to leave the grounds.***

### **FAMILY GAME HORSE SHOW**

**North Country Riding Club Amanda Sherburne [www.dexterridingclub.com](http://www.dexterridingclub.com)  
Sunday, August 29<sup>th</sup> at 9:00 AM in the Horse Pulling Ring.  
All Exhibitors are responsible to clean up after their animals.**

Classes are as follows:

- |                                |                                   |                                     |
|--------------------------------|-----------------------------------|-------------------------------------|
| 1. Carrot Race Lead Line       | 14. Shot Gun Barrels 12 & Under   | 27. Pole Bending 12-17              |
| 2. Carrot Race 12 & Under      | 15. Shot Gun Barrels 13-17        | 28. Pole Bending 18 & Over          |
| 3. Carrot Race 13-17           | 16. Shot Gun Barrels 18 & Over    | 29. Pony Express Lead Line          |
| 4. Carrot Race 18 & Over       | 17. Cloverleaf Barrels Lead Line  | 30. Pony Express 12 & Under         |
| 5. Rescue Bessie Lead Line     | 18. Cloverleaf Barrels 12 & Under | 31. Pony Express 13-17              |
| 6. Rescue Bessie 12 & Under    | 19. Cloverleaf Barrels 13-17      | 32. Pony Express 18 & Over          |
| 7. Rescue Bessie 13-17         | 20. Cloverleaf Barrels 18 & Over  | <b>Day End Awards &amp; Classes</b> |
| 8. Rescue Bessie 18 & Over     | 21. Scramble Lead Line            | <b>Pointed for End of Day</b>       |
| 9. Turn-N-Burn Lead Line       | 22. Scramble 12 & Under           | Lead Line Day End Award             |
| 10. Turn-N-Burn 12 & Under     | 23. Scramble 13-17                | 12 & Under Day End Award            |
| 11. Turn-N-Burn 13-17          | 24. Scramble 18 & Over            | 13-17 Day End Award                 |
| 12. Turn-N-Burn 18 & Over      | 25. Pole Bending Lead Line        | 18 & Over Day End Award             |
| 13. Shot Gun Barrels Lead Line | 26. Pole Bending 12 & Under       |                                     |

***North Country Riding Club wishes to thank  
all the businesses that sponsored today's  
classes.***

## OPEN OX

***Karna Johnson 207-343-4355 or Kevin Jones 207-578-0606***

**Thursday, August 26<sup>th</sup> at Noon**

Weigh-In at 8 AM. Classes will start at noon. 6 foot elimination will start after dinner break. 1 Kids 1200 and under have \$400 to split – Kids 16 and under – May adjust depending on cattle tht show up 2. 1399 & under 3. 1600/2000 4. 2400. 5. 2800 6. 3200 7. 3600/4000 8. Sweepstakes 9 Sweepstakes 6 ft. Depending on how many cattle show up, may adjust classes.

**1 & 2 \$400 to split**

3 through 6 \$85, 75, 65, 55, 45

7 & 8 \$95, 85, 75, 65, 55

9 \$125, 115, 105, 95, 85

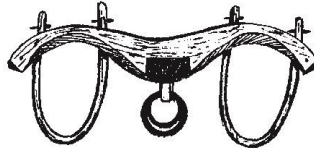

## FARMERS HORSE

***Karna Johnson 207-343-4355 or Kevin Jones 207-578-0606***

**Friday, August 27<sup>th</sup> at Noon in the Horse Pulling Ring.**

1. Twitch - \$65, \$55, \$45, \$35, \$2

2. Scoot- \$75, \$65, \$55, \$45, \$35

NO ALCHOLIC BEVERAGES IN OR AROUND EVENTS, Proof of liability insurance, Negative coggins is required for horses, Use of drugs or stimulants n animals is prohibited, superintendants will be using the Farmers Horse Rules.

## HORSE PULLING

***Karna Johnson 207-343-4355 or Kevin Jones 207-578-0606***

**Saturday and Sunday, August 28<sup>th</sup> & 29<sup>th</sup> @ 10 AM on Saturday**

Weigh In Friday night from 7PM to 8 PM and Saturday morning at 6 AM.

Distance pull classes start at 10 AM Saturday. Saturday weights are good for Sunday if horses stay on the grounds. Classes: 3000, 3200, we will break for lunch and the Ladies Skillet Throw 3400 – Andrew “Andy” Libby Memorial Pull at 1 PM, will break until 4 PM, 3000 & under 12 ft, 3400 & under 12 Ft, Sunday starting at 930 AM – 2lb Rock – light, 2lb rock – heavy, Sweepstakes.

Payouts: 1&2 - \$160, 140, 125, 100, 90, 75 – 3 - \$600, 475, 375, 275, 150, 125 – 4 through 8 - \$160, 140, 125, 100, 90, 75

Rules: NO ALCHOLIC BEVERAGES IN OR AROUND EVENTS, Proof of liability Insurance, Negative coggins is required for horses, Use of drugs or stimulants in animals is prohibited, 25’ foot rule in effect. 30 Lb weight tolerance.

## LIVESTOCK

***Ron Simpson, Supt. 270-1212***

All livestock must be in place on Thursday by noon. Camping spots are available to livestock exhibitors. Livestock exhibitors my be limited to the number of animals allowed to bring. All livestock trailers must be parked in the back parking lot.

No interference with any judges, State Veterinarian or State Official will be allowed when these persons are discharging their duties. Any abusive language by the exhibitor or their attendants shall make these exhibitors liable to be suspended from the priviledges of this fair, livestock show, or exhibition by the livestock superintendent, or Show Committee, and forfeiture of all prize money.

ME Assoc. of Livestock Exhibitors –Membership Application can be found at:  
www.umext.maine.edu/4h/forms/male/memberform.pdf

## DAIRY CENTER EVENTS YOUTH GOAT SHOW

Milking demonstration 6PM Thursday, Friday, and Saturday.

*Sally Peniuk, Show Chairperson 778-0167 Saturday & Sunday August 28<sup>th</sup> & 29<sup>th</sup>*

The Youth Goat Show will be held on Sunday, August 29<sup>th</sup> at 10:30AM. Animals must be in place at the Fairgrounds by no later than 10:00AM on Saturday, August 23<sup>rd</sup> and are required to remain until Sunday. Animals may arrive earlier (Thursday or Friday) but the owner must be on the grounds with the animals.

The Youth Show is open to all youth ages 5-20. Goats do not have to be registered. The animals must be in good health and free from disease and sores. Junior Does, Senior Does, and Wethers are eligible. NO Bucks allowed. Breeds to be shown are: Alpine, Boer, LaMancha, Nigerian Dwarf, Nubian, Oberhasli, Pygmy Recorded Grade, Saanen/Sable, and Toggenburg. Classes will be set-up according to the ages of the goats and the breeds. There are no entry fees required for the Youth Goat Show. This event is sponsored by Piscataquis Valley Fair. All exhibitors are required to participate in the Showing & Fitting Classes. Participants are also encouraged to participate in the Special Events listed below. A herdsman award will be given to the exhibitor demonstrating:

cleanliness/neatness of pen and pen area; cooperation with show personnel, fair officials, other exhibitors; participation and general attitude.

### SATURDAY SPECIAL EVENTS:

*Getting to Know Each Other*

### KNOW YOUR SHEEP WORKSHOP

ALL Exhibitors at Goat Barn 11am

**Costume Parade:** Dress-Up your critter (and yourself). Open to ALL livestock breeders. Show Ring 3pm

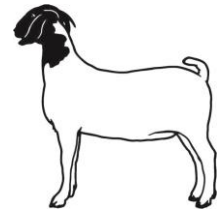

### EXTRA EVENT GOAT BREEDERS!!

**Poster Contest:** Create a poster/display that shows some aspect of life with goats. Creations will be on display and will be judged.

### CENTRAL MAINE SHEEP BREEDERS

*Kim Morris 943-5098*

**Saturday, August 28<sup>th</sup>** Central Maine Sheep Breeders will do a shearing and spinning demo from 10AM-1PM. People who will not be able to bring their wool to the Wool Pool on August 30<sup>th</sup> may put their wool in our building at the fair, preferably on Saturday when one of us will be there. All bags must be labeled with your name and phone number. Please contact Kim Morris if you will be bringing your wool to the fair.

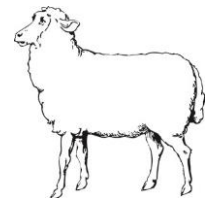

### YOUTH BEEF SHOW

**Saturday, August 28<sup>th</sup> at 10:30AM**

**ALL LIVESTOCK TRAILERS MUST BE PARKED IN BACK PARKING LOT.**

Youth exhibitors can be no older than 21 years old. Classes may be split by breed if there are more than 5 of the same breed, if not they will be shown together or in an all other breed class. Fitting and Showmanship will be divided accordingly to the ages of participants. Pixie Showmanship will include kids under 8 years old. **Class premiums:** 1st - \$30 / 2nd - \$28 / 3rd - \$26 / 4th - \$24 / 5th - \$22

Senior Fitting and Showmanship

Pixie Showmanship

Intermediate Fitting and Showmanship

Market Steers (Windsor/Fryeburg)

Junior Fitting and Showmanship

## HEIFERS

Junior Heifer Calf: 1/1 to 6/30 Senior Calf: 9/1 - 12/31

Summer Yearling: 5/1 - 8/31 Spring Yearling: 3/1 - 4/30 Junior Yearling: 1/1 - 3/31 Senior Yearling: 9/1 - 12/31 2 Yr. Old Female: 1/1 - 8/31 3 Yrs. and Over Female

Champion of Each Breed

### YOUTH DAIRY SHOW

**Friday, August 27<sup>th</sup> at 10:30AM**

Youth exhibitors can be no older than 21 years old.

All Livestock Trailers must be parked in back parking lot. **Class Premiums:**

1st - \$30 / 2nd - \$28 / 3rd - \$26 / 4th - \$24 / 5th - \$22

Senior Fitting and Showmanship Summer Yearling Calf: 6/1 – 8/31

Intermediate Fitting and Junior Yearling Heifer: 3/1 – 5/31

Showmanship Senior Yearling Heifer: 9/1 – 2/28

Junior Fitting and Showmanship

Pixie Showmanship Junior Champion

Junior Heifer Calf: 3/1 – 4/30 Cow, 2 yrs old Intermediate Heifer Calf: 12/1-2/28 Cow, 3 yrs old

Senior Heifer Calf: 9/1 – 11/30 Cow, 4 yrs old

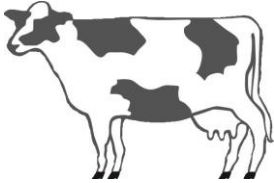

Cow, 5 yrs old and over

Dry Cow

(must have calved at least once and be dry at time of the show)

Senior Champion Grand Champion

**MECHANICAL EVENT RULES ARE AVAILABLE ON THE FAIR WEBSITE  
NO RIDING ON FAIRGROUNDS ~ ENTRANTS SHOULD ENTER GROUNDS AT GATE  
#3.**

---

**FIGURE 8 EXCITEMENT**

**(Enter at Gate #3)**

*Josh Campbell 852-7631 or Dan Bishop 343-1975*

**Thursday, August 26<sup>th</sup> at 6:00 PM at the Mechanical Pulling Track**

Enter Gate #3. All Figure 8 entrants shall pay at the gate plus \$20 registration fee. The competition is open to anyone interested in joining the fun. A pit pass will be necessary to be in the pit. All entrants must be at drivers meeting at 5 PM.

**TUFF TRUCK COMPETITION**

**(Enter at Gate #3)**

*Josh Campbell 852-7631 or Dan Bishop 343-1975*

**Friday, August 27<sup>th</sup> at 6:00 PM at the Mechanical Pulling Track**

Must use Gate #3 and everyone pays at the gate, plus entry fee of \$20. All Trucks must be through the gate by 4:30 PM; anyone arriving after that time will not run.

**TWO CLASSES:** Regular and Stadium.

**Payout:** \$1200

**GARDEN TRACTOR PULLS**

*Josh Campbell – 852-7631*

**Sunday, August 29<sup>th</sup> at 9:00 AM at the Mechanical Pulling**

**Track** It is not necessary to belong to a club to participate in events.

**CLASSES:** Strictly Stock (ages 6-17) - 700 lbs., 900 lbs.; Stock (ages 6-17) - 800 lbs., 1050 lbs., 1300lbs.; Improved Stock (ages 8-17) - 1100 lbs., 1300 lbs.

**PAY BACK - ALL CLASSES:** 1st \$25 / 2nd \$20/ 3rd \$15 / 4th \$10 / 5th \$5

**Garden Tractor Rules and Regulations:**

1. Drivers must be at least 6 yrs. of age but no older than 17 yrs. for the strictly stock, and stock classes.
2. Drivers must be at least 8 yrs. of age but no older than 17 yrs. for the Improved stock classes.
3. Draw bar not to exceed 12" in height and be rigid in all directions. With the exception of strictly stock class with 8" wheels are limited to 8" height without wheelie bars.
4. Weight to include driver and helmet.
5. Each tractor will be checked for safety.
6. Each tractor must have working brakes.
7. Strictly stock and stock tractors are limited to 4000 RPMs
8. Improved Stock are limited to 5000 RPMs
9. All tractors must appear stock, No dealer will be allowed to enter a tractor.
10. Strictly Stock must have turf tires and stock carburation.
11. Stock may run Ag tires but must not be cut.
12. Improved may run cut tires
13. All drivers must wear helmets.
14. All tractors must have wheelie bars, except strictly stock but are strongly recommended.
15. No part of the tractor may interfere with the drag.
16. Any tractor that loses a weight when hooked to the drag will be disqualified.



17. Any part of the tractor or drag that goes out of bounds will be disqualified. With the exception of the strictly stock which will be measured at the point they go out of bounds.
18. Vertical Shaft Over-Head Valve tractors must run in the Improved Stock Class.
19. All decisions of the judge are **FINAL**.

## TRUCK PULLS

(Enter at Gate #3)

*Josh Campbell 852-7631, Bruce Weymouth 299-4373 or Trey Weymouth 907-0487*

**Saturday, August 28<sup>th</sup> at 6:00 PM at the Mechanical Pulling Track.**

Maine State Rules apply. Subject to change per pulling officials. Scales open 1 hour before. All street trucks are welcome. **Mandatory** drivers meeting at 5pm.

Entry fees \$20 per class. 100% to the winners. **Rules for classes on the website.**

### CLASSES:

1. 6500 lb. 1/2 Ton Stock
2. 6500 lb. 1/2 Ton Modified
3. 7500 lb. 3/4 Ton Stock
4. 7500 lb. 3/4 Ton Modified
5. 9000 lb. Street Diesel
6. 9000 lb. Modified Diesel
7. Pro Modified 4x4



## DICK COLLINS MEMORIAL DOODLEBUG DRAW

*Rusty Weymouth 694-0192*

**Sunday, August 29<sup>th</sup> at 10:00 AM at the Mechanical Pulling Track**

**ENTRANTS SHOULD ENTER FAIRGROUNDS AT GATE #3.**

Information and Rules will also be posted on day of event.

## DEMOLITION DERBY

*Josh Campbell 852-7631 or Dan Bishop 343-1975*

**Sunday, August 29<sup>th</sup> at 3:00 PM at the Mechanical Pulling Track.**

**Big Car Payout:** 1st- \$300 / 2nd-\$200 / 3rd-\$100

**Little Car Payout:** 1st-\$300 / 2nd-\$200 / 3rd-\$100

Evergreen Auto Salvage-sponsor of the Powder Puff-\$300

Anyone interested in entering the Derby should get his or her cars built and ready. Drivers must be 16 years (with parental permission) or older. All Demo Derby entrants shall pay at the gate plus a

\$20 registration fee. The competition is open to anyone

interested in joining the fun. A pit pass will be necessary to be in the pit.

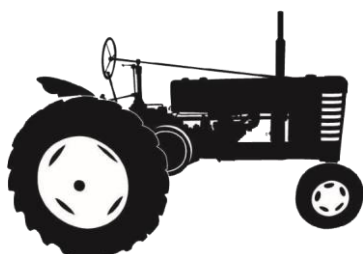
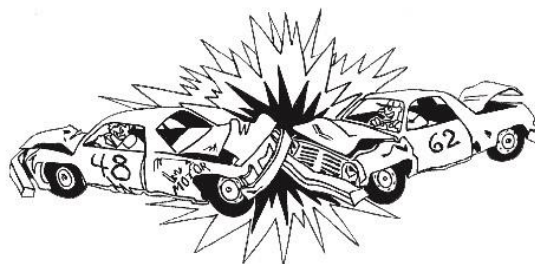

## FARM TRACTOR PULLS

*Josh Campbell 852-7631, Bruce Weymouth 299-4373 or Trey Weymouth 907-0487*

**Saturday, August 28<sup>th</sup> at 10:00 AM**

Maine State Rules apply. Subject to change per pulling officials. Scales open 1 hour before. Entrance fee: \$20 per hook.

**Classes:** 7000 lbs. - 8500 lbs. - 10500 lbs.- 12500 lbs.- 14500 lbs. - 16500

lbs. **Prizes:** 1st - \$100 / 2nd - \$75 / 3rd - \$50

## ANTIQUA AUTOS, ENGINES, & TRACTORS

*Rusty Weymouth 694-0192*

**Saturday, August 28<sup>th</sup> at 10:00 AM**

Antique auto parade onto the ball field and displayed until 2:00 PM.

## CHILDREN'S GAMES

*Contact Keshia Flint 735-6677 or Jasmane Hanson – 735-6045*

We will be having four children's games one for each day of the fair. These games will include:

**Frisbee Toss** - Thursday, August 26<sup>th</sup> at 3:00 PM behind the Ice Cream Parlor.

**Relay Race** - Friday, August 27<sup>th</sup> at 3:00 PM behind the Ice Cream Parlor.

**Three Legged Race** - Saturday, August 28<sup>th</sup> at 4:30 PM on the hill by the Fair Office.

**Wheel Barrel Race** - Sunday, August 29<sup>th</sup> at 11:30 AM on the hill by the Fair Office.



## MISS MAPLE PAGEANT

*Keshia Flint 735-6677 or Danielle Hurd 991-1290*

**Saturday, August 28<sup>th</sup> at 10 AM on the stage**

Participants need to arrive at 9:30AM. **Participants will be divided into grade levels:**

K-4th Grade is first class, 5th-8th Grade is second class, and 9th-12th Grade is third class.

Registration forms are available at the Bear's Den Restaurant and at [piscataquisvalleyfair.com](http://piscataquisvalleyfair.com). All registration forms and music must be turned in by Monday, August 23<sup>rd</sup> in order to participate.

**There will be 3 categories for each class in this order:**

**Agricultural Wear/Country Wear**- Put on your best idea of what country/farm girls would wear.

**Talent**- Can be anything from singing and dancing to tying a knot.

**Formal Wear/Dress-up**- Does not have to be full formal it can be any type of dressy clothes.

Prizes: 1st place prize- Crown, Sash, and \$50.00 / 2nd place prize- \$25.00

Also the 1st place winner of the 9th-12th grade class will also receive a \$200 scholarship.

**Event sponsored by:** Bob's Sugarhouse, The Bear's Den Restaurant, Motel, and Tavern, and Guilford Service Center.

## HORSESHOE TOURNAMENT

*Jason Weston 564-3009*

**Saturday, August 28<sup>th</sup> and Sunday August 29<sup>th</sup> at 10:00 AM**

Participants will pay \$6.00 at the gate and \$4.00 to enter the tournament. Payout is at least \$200.00 each day, plus \$4.00 times how many people enter. Partners will be drawn. This will be held behind the dining hall.



## POWER WHEELS DEMOLITION DERBY

*Jasmane Hanson 207-735-6045*

**Sunday, August 29<sup>th</sup> during the Demo Derby**

Battery operated vehicles only. Children must be size and age appropriate (100 lb. maximum and able to reach the pedals). Bicycle helmets are required for each child participating. The fair has some vehicles and helmets available. *If you have your own vehicle it must have a battery no larger than 12 volts.* Anyone interested must sign up Sunday on the hill by the fair office. Each sign up will be placed in a "round" and given a ticket for that "round" to present when it is called. Children will meet the volunteers by the entrance to the track once their "round" is called. **NO PARENTS ON THE TRACK.**

This is a non-profit event for the fair. ALL proceeds are donated to a children's program/event in the community.

## MAP & KEY OF FAIRGROUNDS

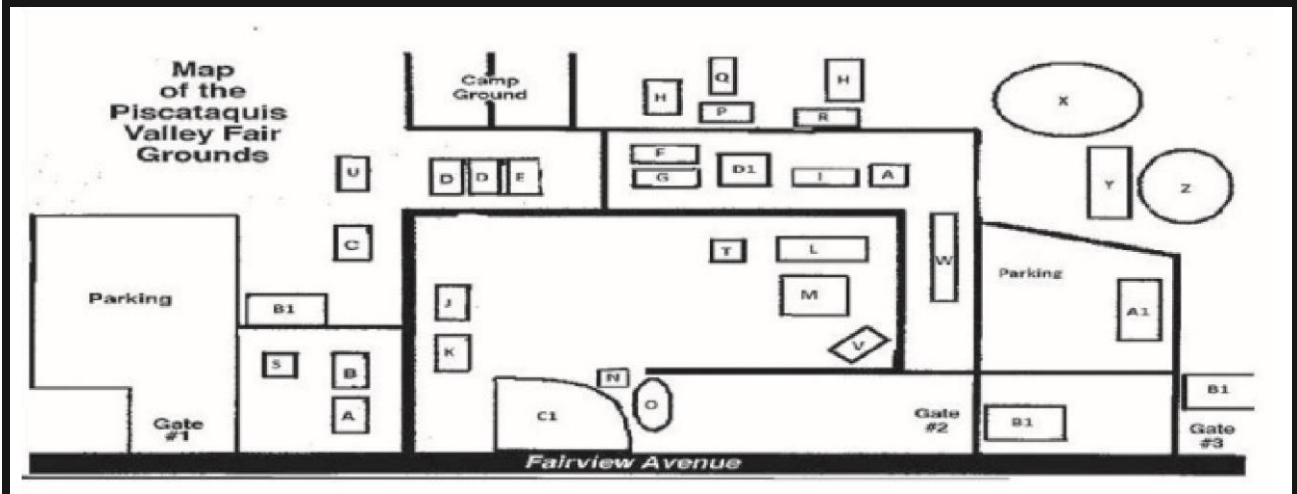

### Fairview Avenue

- |                        |                    |                        |                      |
|------------------------|--------------------|------------------------|----------------------|
| A. Rest Room           | I. Vendor Barn     | Q. Livestock Show Ring | Y. Mechanical Track  |
| B. Dining Hall         | J. DFFD Food Booth | R. Ice Cream Parlor    | Z. Demo Derby Area   |
| C. Sheriff & First Aid | K. Bingo Hall      | S. Vacant Booth        | A1. Draft Horse Barn |
| D. Exhibition Hall     | L. PVFA Food Booth | T. Bob's Sugarhouse    | B1. Ticket Booth     |
| E. 4-H Building        | M. Fair Office     | U. DFFD Museum         | C1. Ball Field       |
| F. Animal Land         | N. Hockey Booth    | V. Stage               | D1. Play Area/Gazebo |
| G. Sheep Barn          | O. Hockey Rink     | W. Horse Pulling Ring  |                      |
| H. Cattle Barn         | P. Milking Parlor  | X. Horse Show Ring     |                      |

More Information available on the web:

[www.PiscataquisValleyFair.com](http://www.PiscataquisValleyFair.com)

Or find us on Facebook