

# PREMIUM BOOK & SCHEDULE OF EVENTS

## *Our 137<sup>th</sup> Year*



77 Fairview Ave., P O Box 197  
Dover-Foxcroft, ME 04426  
(207) 717-9100 Week of Fair Only  
[www.PiscataquisValleyFair.com](http://www.PiscataquisValleyFair.com)

## August 22 – 25, 2024

Thursday/Friday  
Saturday/Sunday

Midway Opens at 2:00 PM  
Midway Opens at 11:00 AM

**Fairgrounds Open at 6:00 AM**

### *A Down Home Country Fair*

**Wrist Bands:** \$20 Thursday  
\$25 Friday, Saturday, Sunday  
Campsites Available

**Admission:** \$10.00 each day (over 12 yrs.)  
\$5.00 (5 – 12 years), under 5 – Free

**Thursday - SENIOR CITIZEN DAY - \$5.00**

*Free Parking on Grounds ~ ATV's always welcome with  
direct access to fairgrounds through Gate #3*

Drinking in public is against State Law

**NO DOGS ALLOWED ON GROUNDS**

(Service Dogs Accepted)

**Remember to use our wash stations after visiting the animals.**





# PISCATAQUIS VALLEY FAIR ASSOCIATION

## OFFICERS

PRESIDENT, Rusty Weymouth .....694-0192  
VICE PRESIDENT, Joe Guyotte .....562-2187  
SECRETARY, Erica Cianci .....943-3601  
TREASURER, Scott Taylor .....564-7738

## DIRECTORS

Brian Westman, Deanne Merrill, Jason Weston,  
Jasmane Hanson, Trisha White, Trey Weymouth,  
Dan Bishop, Josh Campbell, Donna Weymouth

## CONTACT INFORMATION

**Food & Produce:** Erica Cianci.....943-3601  
Wed., Aug. 21<sup>st</sup>, 4 pm - 8 pm at Exhibition Hall #1

**Flower Show:** Terry Ogden..... 564-3963  
Wed., Aug. 21<sup>st</sup>, 4 pm - 8 pm. Exhibition Hall #1

**Home Arts & Crafts:** Tracy Redmond ..... 564-3088.  
Tues., Aug. 20<sup>th</sup>, 2 pm - 7 pm Exhibition Hall #1

**Livestock:** Justin and Crystal Waltman ..... 341-7734 and 270-0588

**Horse and Ox Pulling:** Karna Johnson, Supt. ....343-4355  
Kevin Jones .....578-0606

**Family Game Show:** Nichole Schobel .....478-9532  
[www.dexterridingclub.com](http://www.dexterridingclub.com)

**Central ME Sheep Breeders:** Kim Morris, Pres. ....943-5098

**4-H Exhibits:** Sheila Norman .....564-3301 [Sheila.Norman@maine.edu](mailto:Sheila.Norman@maine.edu)

**Youth Sheep Show:** Kim Morris .....943-5098

**Fun Horse Show:** Angie Clukey .....852-0831 [dtreport@myottmail.com](mailto:dtreport@myottmail.com)

**Farm Ox Events:** Karna Johnson .....343-4355

**Mechanical Track:** Josh Campbell.....852-7631  
Trey Weymouth .....907-0487  
Dan Bishop .....343-1975  
Rusty Weymouth .....694-0192

---

More Information available on the web:  
[www.PiscataquisValleyFair.com](http://www.PiscataquisValleyFair.com)  
Or find us on Facebook

## GENERAL ADMISSION

The gates will open each day of the fair at 6:00 AM. Midway opens Thursday & Friday 2 PM-closing, Saturday & Sunday 11 AM-closing. General Admission \$10.00 per person per day, children 5 to 12 yrs. of age are \$5.00 per person per day, children under 5 are FREE. Senior Citizen Day is Thursday, August 22<sup>nd</sup>. Anyone 65 years of age or older will be admitted for half price. Proof of age is required. Everyday is a Wristband Day. Purchase Wristbands on the midway. **ONLY SERVICE ANIMALS ALLOWED ON THE FAIRGROUNDS.** Show animals allowed in specified areas. Campers must keep pets in the campground. Horse and Livestock trailers must be parked in the back parking lot.

More information is available at  
[www.PiscataquisValleyFair.com](http://www.PiscataquisValleyFair.com)

Find us on Facebook

---



## EXPRESSION OF APPRECIATION

The Fair thanks all the exhibitors, Piscataquis Sheriff's Department, Dover-Foxcroft Fire Department, Mayo Regional Hospital, Central Maine Power, ticket takers, Town's people, Community Fitness, and anyone else who helps to make our Fair successful. Without **YOU** there would be no fair.

## **FIRST AID**

**Darcy Merrill R.N., Supt.** - A First Aid station sponsored by Mayo Regional Hospital will be open on the Fairgrounds during Fair Hours.

## **CAMPING ON GROUNDS**

**Campground Superintendents: Fred Frye** - All campers must enter through Gate 2, Campsites are on a first come first serve basis, \$25.00 per day which includes 20-amp electrical hookup and water. All campers must have a back flow valve. Payment made when you enter the fairgrounds along with your daily entrance fees for all in your party through Sunday. If you choose to leave early a refund will be given at the time that you leave. Campers will be billed for every night that they are on the grounds, whether they are hooked up or not. It is not the responsibility of the campground officials to ask other campers to move so that you can get out, pick your site wisely. Livestock and fair association members should contact the superintendent of their area before arrival on the grounds to get their camping pass. NO non-member campers before Wednesday of the fair.

## **VENDOR GROUNDS RENTAL**

**Trisha White 717-7619** - Grounds rental shall be \$16.00 per front foot, minimum of 10'. Inside space is \$100 single, \$180 double space. Payment is due before setup.

## **DINING HALL RENTAL**

**Deanne Merrill 943-2650** - The Fairgrounds Dining Hall is available for rental during the year. Please call for information, rates, and available dates.

## **PREMIUMS & COMPETITION**

The Directors of the Piscataquis Valley Fair Association reserve the right to withhold payment of any and all premiums until after the completion of the Fair, at which time premiums will be mailed to recipients. The right is also reserved to reduce premiums in the event of inclement weather and/or unforeseen circumstances that greatly impact the income received during the four days of the Fair.

***Disclaimer: The Piscataquis Valley Fair disclaims any liability for loss or damage to exhibits or personal property of exhibitors.***

## **FOOD AT THE FAIR**

**Please use our new wash stations before purchasing or consuming food.**

### **FAIR FOOD BOOTH**

(On the hill, overlooking the pulling area) Breakfast – Thursday, August 22<sup>nd</sup> from 7 AM to 11 AM. Friday, Saturday, and Sunday, August 23<sup>rd</sup>-August 25<sup>th</sup> from 6 AM to 11 AM: Coffee, Juice, full breakfast - eggs, bacon, sausage, home fries. Lunch & Dinner - 11 AM to 10 PM: Burgers, hotdogs, sausages, fries, chicken fingers, homemade pies, water, and soda.

### **ICE CREAM PARLOR**

(Beside the Milking Parlor) Gifford's Ice Cream. Cones, Shakes, Floats, Sundaes, Lots of flavors. Water and soda.

***Many more Food Vendors will be serving your fair favorites.***



## **BOB'S SUGARHOUSE**

***Bob & Barb Moore 564-2145***

Bob's Sugarhouse is located by the Fair Food Booth. Plan to drop by for Barbara's homemade fudge and maple sugar candy. Swap stories of good old days when sap was collected by horse and wagon and boiling down meant around-the-clock over a hot wood fire and a homemade boiling pan.

## **PIG SCRAMBLE**

***Yolanda Burrill***

**Sunday, August 25<sup>th</sup> at 1:00 PM at the Pulling Ring**

Sign-up: 10 AM to Noon Sunday at the fair office. \$2 entry fee. Exciting event. Rules for the Pig Scramble: Participants must be between the ages of 6 and 12. (Three age groups: 6-8 years, 9-10 years, 11-12 years) Must have filled out parental permission slip. **NOT EVERY CHILD THAT SIGNED UP WILL BE PICKED. NOT EVERY CHILD THAT GETS PICKED WILL CATCH A PIG.** Names will be drawn at the start of each age group.

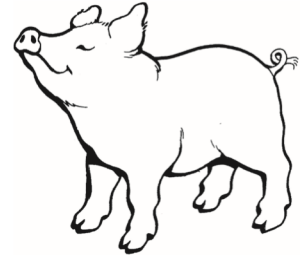

Come learn about how to care for the piglet your child just might catch at this year's pig scramble. Colt W. Knight, PhD - Associate Extension Professor and State Livestock Specialist will talk about how to house, feed, and raise a healthy piglet. Join us at the fair office at 12 noon. The talk will begin right after the bike drawing and the pig scramble will start at 1:00.

## **LADIES SKILLET THROW**

***Karna Johnson – 343-4355***

**Saturday, August 24<sup>th</sup> at 11:30 AM in the Horse Pulling Ring**

Ladies need to register by 11:30 AM. Sign up sheets are in the Fair Office any time Saturday morning. Age Groups: 18-35: 1st \$30, 2nd \$20, 3rd \$10; 36-49: 1st \$30, 2nd \$20, 3rd \$10; 50-64: 1st \$30, 2nd \$20, 3rd \$10; 65 & over: 1st \$30, 2nd \$20, 3rd \$10. Winners of their age group will throw for overall ribbon.

## **WRIST WRESTLING**

***Gary Sudsbury 564-2931***

**Saturday, August 24<sup>th</sup> at 6 PM**

Signup 5:30 PM

Eliminations trials run until a winner is decided in each weight class. Trials are for both men and women going by weight. USA Arm sports Rules and Regulations will apply. Intoxication, alcohol consumption or unruly behavior or language is prohibited. Find the rules on the website.



# ENTERTAINMENT



## STAGE -

- ★ **Borderline Express**  
Thursday, August 22<sup>nd</sup> 6:00 PM - 9:00 PM
- ★ **Jason Tardy - High Energy Juggling**  
Friday, August 23<sup>rd</sup> 1:00 PM - 1:45 PM
- ★ **Jason Tardy - High Energy Juggling**  
Friday, August 23<sup>rd</sup> 3:00 PM - 3:45 PM
- ★ **Voyn**  
Friday, August 23<sup>rd</sup> 7:00 PM - 10:00 PM
- ★ **Dark Rain**  
Saturday, August 24<sup>th</sup> 3:00 PM – 5:00 PM
- ★ **Lexi James + Wildheart**  
Saturday, August 25<sup>th</sup> 7:00 PM – 10:00 PM

## GAZEBO -

- ★ **Karaoke with Adam**  
Friday, August 23<sup>rd</sup> 12:00 PM - 2:00 PM
- ★ **Brent Austin**  
Friday, August 23<sup>rd</sup> 2:00 PM - 3:30 PM
- ★ **Troy Youngblood**  
Friday, August 23<sup>rd</sup> 3:30 PM - 5:00 PM
- ★ **Josiah Dyer**  
Saturday, August 24<sup>th</sup> 12:30 PM - 2:00 PM
- ★ **Frank + Judy**  
Saturday, August 24<sup>th</sup> 2:00 PM - 3:30 PM
- ★ **Ritchie Kenefic**  
Saturday, August 24<sup>th</sup> 3:30 PM - 5:00 PM
- ★ **Chris Flaherty**  
Sunday, August 25<sup>th</sup> 11:30 PM – 1:00 PM

## FLOWER SHOW, HOME ARTS & CRAFTS, FOOD & PRODUCE

*Disclaimer: The Piscataquis Valley Fair (PVF) will provide care and protection of all exhibits. However, PVF distinctly disclaims any liability for loss or damage to exhibits or personal property. This year's competitions have been updated. The structure and premiums have been modified to be closer to competitions at other Fairs. The Fair Flyer now provides information about competitions.*

### FLOWER SHOW

**Terry Ogden 564-3963**

Located in Exhibition Hall #1.

Bring flowers Wednesday, August 21<sup>st</sup> 4-8 PM. Sunday pickup times 4-5 PM.

Premiums - Adult: 1st \$6, 2nd \$4, 3rd \$2

Youth: 1st \$3, 2nd \$2, 3rd \$1

Only one entry per category per person is allowed.

Categories: Fresh Flower Arrangements, Flowering Plants, Foliage Plants, Specimens: (Cut Flowers, 1 stem per container – containers provided). Judging at 10 am on Thursday. Best of Show for Flower Arrangement ONLY.



### HOME ARTS AND CRAFTS

**Tracy and Nan Redmond 564-3088**

RULES and REGULATIONS:

Only one entry per category per person is allowed.

**All entries must be made by the person offering them for exhibit.**

1. Please provide a list of your articles with your name, address, and phone number. If you made something that does not fit our categories, we will attempt to find a place for it.
2. Judging will be determined on general appearance, design, workmanship, age of exhibitor and usefulness of article.
3. All handiwork must have been completed within the fair year (August 2023 – August 2024)
4. Enter articles between 2 and 7 PM Tuesday August 20<sup>th</sup> at Exhibition Hall #1 at the Fairgrounds.
5. Articles must be picked up Sunday, August 25<sup>th</sup> after 5 PM. **ANY ITEM PICKED UP PRIOR TO 5 PM ON SUNDAY WILL FORFEIT THEIR PREMIUMS.**
6. We reserve the right to reject any article that is unfinished, soiled, ripped, or damaged or not in keeping with the above-listed rules and regulations. We reserve the right to limit the number of items submitted by individuals or families.

Categories are: Afghans, bedspreads, lap robes, centerpieces, doilies, pillows, vests, quilts, baby items, sweaters, mittens, socks, macramé, wall hangings, Christmas items, dolls, toys, plastic canvas, hooked & braided rugs, chair seats, baskets, jewelry, candles, paintings, photographs (still life, nature, animals, people); must be framed to protect them from dust in the Exhibition Hall), tablecloths, napkins, and place mats.

Premiums: 1st \$10, 2nd \$8, 3rd \$5. Youth: 1st \$3, 2nd \$2, 3rd \$1. Judges Choice – Adult \$25 – Youth \$10



---

More Information available on the web:

[www.PiscataquisValleyFair.com](http://www.PiscataquisValleyFair.com)

Or find us on Facebook

## FOOD AND PRODUCE

**Erica Cianci 943-3601**

Includes fresh produce, canned goods, and specified baked goods.

### 2024 FOOD & PRODUCE SCHEDULE SUMMARY

Wednesday	4 pm – 8 pm	Bring entries for foods, produce & muffins to Exhibition Hall #1
Thursday	10:00 am Noon	Judging for food & produce Fair Opens
Saturday	10 am - Noon	Cookie Decorating on the hill by office
Sunday	8 am - 10 am 10:30 am 5 - 6 pm 5 - 6 pm	Bring Apple Pies to Exhibit. Hall #1 Pie Judging Pick up prize money-Exhibit. Hall #1 Pick up items

### PRODUCE

Only one entry per category per person is allowed. **Rules [www.PiscataquisValleyFair.com](http://www.PiscataquisValleyFair.com)**

**Categories:** Vegetables – Beans, Snap & Pole (10), Onions (3)-braided tops for hanging 2 varieties, Beans Dry (Jacob, Yellow eye, Pea, other) & Shell (1 cup) 1 variety, Parsnips (3), Beets (3) Early Wonder, Detroit, Red Ball, Peas (10 pods) snow, sugar snaps, other, Broccoli (1), Peppers (3) Green, Red, Yellow, Jalapeño, Brussel Sprouts (10), Potatoes (3) 6 varieties, Cabbage (1), Pumpkin (1), Carrots (3), Radishes (3), Cauliflower (1), Squash-summer (1) & winter (1), Corn (3), Decorative corn (3 braided), Cucumbers (3), Tomatoes (3), Cherry Tomatoes (1 pint), Gourds (1), Greens (bunch) 3 varieties, Turnips (1), Lettuce (1 head), Zucchini.

Berries & Fruits: Apples (3), Blackberries (1 pint), Blueberries (1 pint), Cherries (1 pint), Grapes (1 bunch), Pears (3), Raspberries (1 pint). Cover pints of berries with clear plastic wrap to prevent fruit flies.

**Premiums:** Adult: 1st - \$8 / 2nd - \$6 / 3rd - \$3. Youth: 1st - \$3 / 2nd - \$2 / 3rd - \$1.

### HOME CANNED FOODS

Adults and Youth (16 and under)

**Categories C1 – C4:** 1st \$6, 2nd \$4, 3rd \$2 plus Ribbons.

Must be canned by exhibitor within 1 year. **Jars must be labeled on side with product name, date processed, processing method and processing time.** Minimum of two (2) varieties in each category.

Category	Description	Category	Description
C1	Fruits	C3	Pickled Foods
C2	Vegetables	C4	Soft Spreads (Jams & Jellies)

### BREADS, BISCUITS, ROLLS & MUFFINS

Junior and Adult Divisions 1st \$8, 2nd \$6, 3rd \$5 Judge's Choice \$25

Sweet breads & yeast breads – ½ loaf

Biscuits, rolls, & muffins - Enter THREE (3) Muffins on a disposable plate. Cover food w/ plastic wrap. All baked goods are tasted. Must be accompanied by the recipe printed on a 4 x 6-inch card. Will be judged on appearance, texture, and taste. Entries will not be returned.

### APPLE PIE CONTEST

Submit pies on Sunday, August 25<sup>th</sup>, from 8-10 AM at Exhibition Hall #1. Judging at 10:30 am

Premiums: (3 prizes) \$20, \$15, \$10 plus ribbons. Judges Choice: \$25

Open to all pie bakers. Bring the recipe printed on a 4 x 6 card. Please submit ONE PIE ONLY for judging. Bake the pie the day before. Warm pies cannot be judged properly. Judged on ease of preparation, texture, flavor, and overall appearance. Use a disposable pan.

## COOKIE DECORATING

*Debbie Smart*

**Saturday, August 24<sup>th</sup> 10A M-Noon under the tent on the hill.**

Kids Cookie Decorating. Cookies and decorating supplies provided by Piscataquis Valley Fair Association.

## MILKING PARLOR

Piscataquis Valley Fair is proud to present our new milking parlor built in 2011. It sports an inside walkway for better viewing of the daily milking demonstrations (about 6PM Thursday, Friday, and Saturday) and an extensive display of Maine milk bottles and antique milking equipment.

## GRANGE EXHIBITS

*Bill Bemis 924-3537* Exhibition Hall #1

Open to any Grange. Display to include a variety of products raised or made by members of each organization. Each display will be placed in an area approx. 10'. Judged by Maine State Grange "Judging Guidelines for Grange Fair Exhibits".

## ANIMAL LAND

*Debbie Banks 924-3345 and Dickie Hanscom 270-2352*

Please use our wash stations after visiting the animals.

Hours: Thursday – Saturday 9 AM to 7 PM. Sunday 9 AM to 5 PM

Reminder to all visitors of Animal Land: the animals are not in their usual homes so they can bite. Please keep young children safe.

## 4-H YOUTH EXHIBIT RULES

*Sheila Norman 564-3301 or email at "Sheila.Norman@maine.edu"*

1. Entries are open to 4-H members and clubs in Piscataquis, Somerset, and Penobscot Counties who are working on approved 4-H projects.
2. Entries must be from current 4-H projects for the 2023-2024 4-H year. Exhibits will be judged by the Danish system and will be placed in three groups, BLUE-1st, RED-2nd, and WHITE-3rd. Each qualifying exhibit will be awarded a ribbon and premium. All cloverbuds (5 to 8 yrs.) will receive a green ribbon and honorarium.
3. All exhibits must be brought to the Bell Building at the fairgrounds on Tuesday, August 20th from 3- 6 PM. They must be removed from the Bell Building on Sunday, August 25th from 4-5 PM.
4. Exhibits must be prepared by youth members.
5. Contact Sheila at the Extension office before Monday, August 19 if your club plans on having a club exhibit. 4-H club exhibits must be set up between 3 PM & 6 PM on Tuesday August 20 and picked up between 4 PM & 5 PM on August 25. For more information to <https://extension.umaine.edu/piscataquis/4-h/>
6. For information and Exhibition Hall Rules go to: <https://extension.umaine.edu/piscataquis/4-h/> or contact Sheila Norman at 564-3301 or email at [Sheila.Norman@maine.edu](mailto:Sheila.Norman@maine.edu)

**Sunday, August 25th** Come learn about how to care for the piglet you (or your child) just might catch at this year's pig scramble. Colt W. Knight, PhD - Associate Extension Professor and State Livestock Specialist will talk about how to house, feed, and raise a healthy piglet. Join us at the fair office at 12 noon. The talk will begin right after the bike drawing and the pig scramble will start at 1:00.

**Disclaimer:**

The Piscataquis Valley Fair (PVF) will provide care and protection of all exhibits. However, PVF distinctly disclaims any liability for loss or damage to exhibits or personal property. This year's competitions have been updated. The structure and premiums have been modified to be closer to competitions at other Fairs. The Fair Flyer now provides information about competitions.

## PISCATAQUIS VALLEY FAIR FUN HORSE SHOW

Organized by FOXCROFT PONY CLUB

Contact Nicole Schobel (207) 478-9532 or email: [nsschobel@gmail.com](mailto:nsschobel@gmail.com)

Saturday, August 24, 2024 --- Start Time 8:30 am

ENTRY FEES: \$5 per class or \$30 for the day. Checks made payable to Foxcroft Pony Club. Current Negative Coggins and Rabies Vaccination certificates are required. All open classes are W/T/C. You cannot enter both classes 4 and 5, you must enter only one.

JUDGE: Janine Hawkins

CLASSES MAY BE COMBINED IF LOW ENTRIES BUT JUDGED SEPARATE

RIDER AGE GROUPS: W/T/C 12 & under - Junior 13 through 17 - Senior 18 and over

W/T 15 & under – 16 and over

### CLASS LIST:

- |  |   |
|--|---|
| 1. Showmanship 12 & under                          | 23. Equitation Over Fences 2'   |
| 2. Showmanship Jr                                  | 24. Equitation Over fences 2'6"                                       |
| 3. Showmanship Sr                                  | 25. PRIZE Gambler's Choice W/T/C – All Ages                           |
| 4. PRIZE Western Halter Stakes                     | 26. Bare Back Equitation  |
| 5. PRIZE English Horse in hand                     | 27. W/T Western Equitation 15 & under                                 |
| 6. W/T English Equitation 15 & under               | 28. W/T Western Equitation 16 and over                                |
| 7. W/T English Equitation 16 and over              | 29. W/T/C Western Equitation 12 & under                               |
| 8. W/T/C English Equitation 12 & under             | 30. W/T/C Western Equitation Jr                                       |
| 9. W/T/C English Equitation Jr                     | 31. W/T/C Western Equitation Sr                                       |
| 10. W/T/C English Equitation Sr                    | 32. W/T Western Pleasure 15 & under                                   |
| 11. W/T English Pleasure 15 & under                | 33. W/T Western Pleasure 16 and over                                  |
| 12. W/T English Pleasure 16 and over               | 34. PRIZE W/T Western Pleasure Stakes – All ages                      |
| 13. PRIZE W/T English Pleasure Stakes – All ages   | 35. W/T/C Western Pleasure 12 & under                                 |
| 14. W/T/C English Pleasure 12 & under              | 36. W/T/C Western Pleasure Jr   |
| 15. W/T/C English Pleasure Jr                      | 37. W/T/C Western Pleasure Sr   |
| 16. W/T/C English Pleasure Sr                      | 38. Prize Western Pleasure Stakes – All ages                          |
| 17. PRIZE W/T/C English Pleasure Stakes – All Ages | 39. Rescue Ralph  |
| 18. Leadline – 7 and under Equitation              | 40. Carrot Race   |
| 19. Leadline – 7 and under Pleasure                | 41. Sack Race   |
| ****Break and set up Jump Course****               | 42. Groom's Class – Entries must not have ridden in any other classes |
| 20. Costume Class                                  |   |
| 21. W/T 18" Cross rails                            |   |
| 22. Equitation Over Fences 18"                     |   |

Classes pointed for day -end awards for each age group: W/T and W/T/C divisions:

W/T 15 & under – 1 or 2, 6, 11, 21, 27, 32

W/T 16 and over – 2 or 3, 7, 12, 21, 28, 33

W/T/C 12 & under – 1, 8, 14, (22, 23 or 24), 29, 35

W/T/C Jr – 2, 9, 15, (22, 23 or 24), 30, 36

W/T/C Sr – 3, 10, 16, (22, 23 or 24), 31, 37

**Riders and spectators are entering premises at their own risk. PVF or any of its members/agents shall not be liable for claims or damages arising out of injury to any person, horse or damage to any property.**

***Improper conduct towards animals or people will not be tolerated.  
Offenders may be asked to leave the grounds.***

**FAMILY GAME HORSE SHOW**

*North Country Riding Club Amanda Sherburne      [www.dexterridingclub.com](http://www.dexterridingclub.com)*

**Sunday, August 25<sup>th</sup> at 9:00 AM in the Horse Pulling Ring.**

***All Exhibitors are responsible to clean up after their animals.***

Classes are as follows:

- |                                |                                   |
|--------------------------------|-----------------------------------|
| 1. Ride-a-Buck Race Lead Line  | 17. Shot Gun Barrels Lead Line    |
| 2. Ride-a-Buck Race 12 & Under | 18. Shot Gun Barrels 12 & Under   |
| 3. Ride-a-Buck Race 13-17      | 19. Shot Gun Barrels 13-17        |
| 4. Ride-a-Buck Race 18 & Over  | 20. Shot Gun Barrels 18 & Over    |
| 5. Rescue Bessie Lead Line     | 21. Cloverleaf Barrels Lead Line  |
| 6. Rescue Bessie 12 & Under    | 22. Cloverleaf Barrels 12 & Under |
| 7. Rescue Bessie 13-17         | 23. Cloverleaf Barrels 13-17      |
| 8. Rescue Bessie 18 & Over     | 24. Cloverleaf Barrels 18 & Over  |
| 9. Big "T" Lead Line           | 25. Pole Bending Lead Line        |
| 10. Big "T" 12 & Under         | 26. Pole Bending 12 & Under       |
| 11. Big "T" 13-17              | 27. Pole Bending 13-17            |
| 12. Big "T" 18 & Over          | 28. Pole Bending 18 & Over        |
| 13. Jackpot Barrels Lead line  | 29. Pony Express Lead Line        |
| 14. Jackpot Barrels 12 & Under | 30. Pony Express 12 & Under       |
| 15. Jackpot Barrels 13-17      | 31. Pony Express 13-17            |
| 16. Jackpot Barrels 18 & over  | 32. Pony Express 18 & Over        |

**ALL EXHIBITORS ARE RESPONSIBLE TO CLEAN UP AFTER THEIR ANIMALS**

**DAY END AWARDS & Classes Pointed for End of Day**

Lead line Day end Award

12 & under Day end Award

13-17 Day End Award

18 & Over Day End Award

**NCRC wishes to thank all the businesses that sponsored  
today's classes!**

## FARMERS STEER AND OX

**Karna Johnson 207-343-4355 or Kevin Jones 207-578-0606**

**Friday, August 23<sup>rd</sup> at 10 AM in the Horse pulling Ring**

Weigh in Thursday 6:00 PM for Farm Cattle ONLY

Friday 7:00 AM for Steer & Oxen ONLY

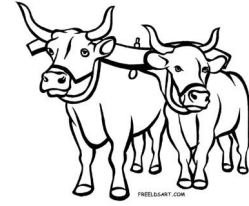

1. **Medium** - \$95, \$85, \$75, \$65, \$55, \$45

2. **Heavy** - \$105, \$95, \$85, \$75, \$65, \$55

**Kids class** Friday at 1pm

**Once weighed in cattle must stay on the grounds.**

## HORSE & OX PULLING

**Karna Johnson 207-343-4355 or Kevin Jones 207-578-0606**

**Friday, August 23<sup>rd</sup> start at 10:00 AM** Farmers Steer & Ox Distance Class

Scales open at 7:00 AM

1. 2 distance classes - will be split at the discretion of the superintendent

**Friday, August 23<sup>rd</sup> start at 1:00 PM** Steer & Ox Pulling All Day

Scales open at 7:00 AM - Weight is good for Saturday

Scales open at 7:00 PM for Saturday

1. Kids 1100 & Under and 1300 & Under

2. 1600

3. 2000

4. 2400

5. 2800 6 ft Short Pull

**Saturday, August 24<sup>th</sup> start at 9:00 AM** Horse & Ox Pulling All Day

Scales open 7:00 PM for Saturday or weigh at 6:00 AM Saturday - Weight is good for Sunday

6. 3100 Horses

7. 2800 Cattle

8. 3200 Horses

9. 3200 Cattle

**Ladies Skillet Toss at NOON**

10. 3400 Andy Libby Memorial - 1PM

11. 3600-4000 Cattle

12. 3100 & Under 12' Elimination

13. 3200 & Under 12' Elimination

14. Sweepstakes Cattle 6' Short Pull

**Sunday, August 25<sup>th</sup> start at 9:30 AM** Horse Pulling

Scales open at 6 AM

15. 2lb Rock - Light

16. 2lb Rock - Heavy

17. Sweepstake Horses

Horse allowance 30 lbs per team.

Cattle allowance is 100 lbs per team.

*\*Schedule may change depending on how many teams show up.\**

**Scales Open:** Thursday 6pm for Cattle Only  
 Friday 7am for Steer & Oxen ONLY  
 Friday 7pm for anyone pulling Saturday or Sunday  
 Saturday 6am for anyone pulling Saturday or Sunday that didn't weigh Friday night  
 Sunday 6am for anyone pulling Sunday that didn't previously weigh in

**Once weighed in must stay on the grounds.**  
**No alcoholic beverages in or around the pulling ring.**  
**Must show proof of insurance.**  
**Horse must show proof negative coggins.**  
**25 foot rule will be in effect – no premium awarded if you do not cross 25ft.**

**Farm Horse Event**

*Karna Johnson 207-343-4355*

**Thursday, August 22<sup>nd</sup> classes start at 10:00 AM**

Twitch	\$60.00	\$50.00	\$40.00	\$30.00	\$25.00
Scoot	\$85.00	\$75.00	\$65.00	\$55.00	\$45.00
Mystery	\$50.00	\$40.00	\$30.00	\$25.00	\$25.00
Kids	\$25.00	\$25.00	\$25.00	\$25.00	\$25.00

*\*Will be run by the FDHMA.\**

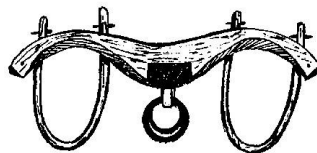

## LIVESTOCK

**Justin and Crystal Waltman 341-7734 and 270-0588**

All livestock must be in place on Thursday by noon. Camping spots are available to livestock exhibitors. Livestock exhibitors may be limited to the number of animals allowed to bring. All livestock trailers must be parked in the back parking lot.

No interference with any judges, State Veterinarian or State Official will be allowed when these persons are discharging their duties. Any abusive language by the exhibitor or their attendants shall make these exhibitors liable to be suspended from the privileges of this fair, livestock show, or exhibition by the livestock superintendent, or Show Committee, and forfeiture of all prize money.

ME Assoc. of Livestock Exhibitors –Membership Application can be found at:

[www.umext.maine.edu/4h/forms/male/memberform.pdf](http://www.umext.maine.edu/4h/forms/male/memberform.pdf)

### DAIRY CENTER EVENTS YOUTH GOAT SHOW

Milking demonstrations 6 PM Thursday, Friday, and Saturday.

**Joe Sabins 595-5790**

**Saturday & Sunday August 24<sup>th</sup> & 25<sup>th</sup>**

The Youth Goat Show will be held on Sunday, August 25<sup>th</sup> at 10:30AM. Animals must be in place at the Fairgrounds by no later than 10:00AM on Saturday, August 24<sup>th</sup> and are required to remain until Sunday. Animals may arrive earlier (Thursday or Friday) but the owner must be on the grounds with the animals. The Youth Show is open to all youth ages 5-20. Goats do not have to be registered. The animals must be in good health and free from disease and sores. Junior Does, Senior Does, and Wethers are eligible. NO Bucks allowed. Breeds to be shown are: Alpine, Boer, LA Mancha, Nigerian Dwarf, Nubian, Oberhasli, Pygmy Recorded Grade, Saanen/Sable, and Toggenburg. Classes will be set-up according to the ages of the goats and the breeds. There are no entry fees required for the Youth Goat Show. This event is sponsored by Piscataquis Valley Fair. All exhibitors are required to participate in the Showing & Fitting Classes. Participants are also encouraged to participate in the Special Events listed below. A herdsman award will be given to the exhibitor demonstrating: cleanliness/neatness of pen and pen area; cooperation with show personnel, fair officials, other exhibitors; participation and general attitude.

### SATURDAY SPECIAL EVENTS:

*Getting to Know Each Other*

### KNOW YOUR SHEEP WORKSHOP

ALL Exhibitors at Goat Barn 11am

**Costume Parade:** Dress-Up your critter (and yourself). Open to ALL livestock breeders. Show Ring 3pm

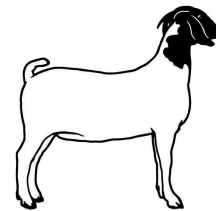

### EXTRA EVENT GOAT BREEDERS!!

**Poster Contest:** Create a poster/display that shows some aspect of life with goats. Creations will be on display and will be judged.

### CENTRAL MAINE SHEEP BREEDERS

**Kim Morris 943-5098**

**Saturday, August 24<sup>th</sup>** Central Maine Sheep Breeders will do a shearing and spinning demo from 10AM-1PM. People who will not be able to bring their wool to the Wool Pool on August 26<sup>th</sup> may put their wool in our building at the fair, preferably on Saturday when one of us will be there. All bags must be labeled with your name and phone number. Please contact Kim Morris if you will be bringing your wool to the fair.

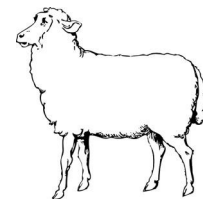

## YOUTH BEEF SHOW

**Saturday, August 24<sup>th</sup> at 10:30AM**

**ALL LIVESTOCK TRAILERS MUST BE PARKED IN BACK PARKING LOT.**

Youth exhibitors can be no older than 21 years old. Classes may be split by breed if there are more than 5 of the same breeds, if not they will be shown together or in an all-other breed class. Fitting and Showmanship will be divided accordingly to the ages of participants. Pixie Showmanship will include kids under 8 years old. **Class premiums:** 1st - \$30 / 2nd - \$28 / 3rd - \$26 / 4th - \$24 / 5th - \$22

Senior Fitting and Showmanship  
Intermediate Fitting and Showmanship  
Junior Fitting and Showmanship

Pixie Showmanship  
Market Steers (Windsor/Fryeburg)

## HEIFERS

Junior Heifer Calf: 1/1 to 6/30 Senior Calf: 9/1 - 12/31

\Summer Yearling: 5/1 - 8/31 Spring Yearling: 3/1 - 4/30 Junior Yearling: 1/1 - 3/31 Senior Yearling: 9/1 - 12/31 2 Yr. Old Female: 1/1 - 8/31 3 Yrs. and Over Female

Champion of Each Breed

Junior Heifer Calf: 3/1 – 4/30

Cow, 2 yrs. old

Intermediate Heifer Calf: 12/1-2/28

Cow, 3 yrs. old Senior Heifer Calf:

9/1 – 11/30

Cow, 4 yrs. old

Cow, 5 yrs. old and over

## YOUTH DAIRY SHOW

**Friday, August 23<sup>rd</sup> at 10:30AM**

Youth exhibitors can be no older than 21 years old. All Livestock Trailers must be parked in back parking lot.

**Class Premiums:**

1st - \$30 / 2nd - \$28 / 3rd - \$26 / 4th - \$24 / 5th - \$22

Senior Fitting and Showmanship Summer Yearling Calf: 6/1 – 8/31

Intermediate Fitting and Junior Yearling Heifer: 3/1 – 5/31

Showmanship

Senior Yearling Heifer: 9/1 – 2/28

Junior Fitting and Showmanship

Pixie Showmanship

Junior Champion

Dry Cow (Must have calved at least once and be dry at time of the show)

Senior Champion Grand Champion

***Disclaimer:***

***The Piscataquis Valley Fair disclaims any liability for loss or damage to exhibits or personal property of exhibitors.***

## MECHANICAL

**EVENT RULES ARE AVAILABLE ON THE FAIR WEBSITE NO RIDING ON FAIRGROUNDS ~ ENTRANTS SHOULD ENTER GROUNDS AT GATE #3.**

### FIGURE 8 EXCITEMENT

**(Enter at Gate #3)**

*Dan Bishop 343-1975*

**Thursday, August 22<sup>nd</sup> at 6:00 PM at the Mechanical Pulling Track**

Enter Gate #3. All Figure 8 entrants shall pay at the gate plus \$20 registration fee. The competition is open to anyone interested in joining the fun. A pit pass will be necessary to be in the pit. All entrants must be at drivers meeting at 5 PM.

### TUFF TRUCK COMPETITION

**(Enter at Gate #3)**

*Dan Bishop 343-1975*

**Friday, August 23<sup>rd</sup> at 6:00 PM at the Mechanical Pulling Track**

Must use Gate #3 and everyone pays at the gate, plus entry fee of \$20. All Trucks must be through the gate by 4:30 PM; anyone arriving after that time will not run.

**TWO CLASSES:** Regular and Stadium.

**Payout:** \$1200

### GARDEN TRACTOR PULLS

*Josh Campbell 852-7631 Trey Weymouth 907-0487*

**Sunday, August 25<sup>th</sup> at 9:00 AM at the Mechanical Pulling Track**

It is not necessary to belong to a club to participate in events.

**Drivers meeting to be held at 8:30 AM. All drivers must be present to participate**

**CLASSES:** Strictly Stock (ages 6-17) - 800 lbs., 900 lbs.; Stock (ages 6-17) - 800 lbs., 1050 lbs., 1300lbs.; Improved Stock (ages 8-17) - 1100 lbs., 1300 lbs.

**PAY BACK - ALL CLASSES:** 1st \$25 / 2nd \$20/ 3rd \$15 / 4th \$10 / 5th \$5

#### **Garden Tractor Rules and Regulations:**

1. Drivers must be at least 6 yrs. of age but no older than 17 yrs. for the strictly stock, and stock classes.
2. Drivers must be at least 8 yrs. of age but no older than 17 yrs. for the Improved stock classes.
3. Draw bar not to exceed 12" in height and be rigid in all directions. Except for strictly stock class with 8" wheels are limited to 8" height without wheelie bars.
4. Weight to include driver and helmet.
5. Each tractor will be checked for safety.
6. Each tractor must have working brakes.
7. Strictly stock and stock tractors are limited to 4000 RPMs.
8. Improved Stock are limited to 5000 RPMs.
9. All tractors must appear stock, no dealer will be allowed to enter a tractor.
10. Strictly Stock must have turf tires, stock carburation, and a muffler.
11. Stock may run Ag tires but must not be cut.



---

More Information available on the web:

**[www.PiscataquisValleyFair.com](http://www.PiscataquisValleyFair.com)**

Or find us on Facebook

12. Improved may run cut tires.
13. All drivers must wear helmets.
14. All tractors must have wheelie bars, except strictly stock but are strongly recommended.
15. No part of the tractor may interfere with the drag.
16. Any tractor that loses a weight when hooked to the drag will be disqualified.
17. Any part of the tractor or drag that goes out of bounds will be disqualified. With the exception of the strictly stock which will be measured at the point they go out of bounds.
18. Vertical Shaft Overhead Valve tractors must run in the Improved Stock Class.
19. Each driver may only pull first in one class.
20. All decisions of the judge are **FINAL**.

## TRUCK PULLS

(Enter at Gate #3)

*Josh Campbell 852-7631 or Bruce Weymouth 299-4373  
or Trey Weymouth 907-0487*

**Saturday, August 24<sup>th</sup> at 6:00 PM at the Mechanical Pulling Track.**

**Maine State Rules apply.**

**Points pull for Maine State Pulling all fees and payouts handled by Maine State Pulling.**

For classes and more information please visit <https://www.facebook.com/groups/137665889581823/>.



## DICK COLLINS MEMORIAL DOODLEBUG DRAW

*Rusty Weymouth 694-0192*

**Sunday, August 25<sup>th</sup> at 10:00 AM at the Mechanical Pulling Track**

**Entrance SHOULD ENTER FAIRGROUNDS AT GATE #3.**

Information and Rules will also be posted on day of event.

## DEMOLITION DERBY

*Dan Bishop 343-1975*

**Sunday, August 25<sup>th</sup> at 3:00 PM at the Mechanical Pulling Track.**

**Big Car Payout:** 1st- \$300 / 2nd-\$200 / 3rd-\$100

**Little Car Payout:** 1st-\$300 / 2nd-\$200 / 3rd-\$100

Evergreen Auto Salvage-sponsor of the Powder Puff-\$300

Anyone interested in entering the Derby should get his or her cars built and ready. Drivers must be 16 years (with parental permission) or older. All Demo Derby entrants shall pay at the gate plus a

\$20 registration fee. The competition is open to anyone interested in joining the fun. A pit pass will be necessary to be in the pit.



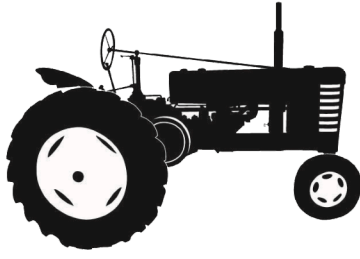

## FARM TRACTOR PULLS

*Josh Campbell 852-7631 or Bruce Weymouth 299-4373 or Trey Weymouth 907-0487*

**Saturday, August 24<sup>th</sup> at 10:00 AM**

Maine State Rules apply. Subject to change per pulling officials. Scales open 1 hour before. Entrance fee: \$20 per hook.

**Classes:** 7000 lbs. - 8000 lbs. - 9000 lbs.- 10500 lbs.- 12500 lbs. - 14500 lbs. **Prizes:** 1st - \$100 / 2nd - \$75 / 3rd - \$50

## ANTIQUE AUTOS, ENGINES, & TRACTORS

*Rusty Weymouth 694-0192*

**Saturday, August 24<sup>th</sup> at 10:00 AM**

Antique auto parade onto the ball field and displayed until 2:00 PM.

## CHILDREN'S GAMES

*Donna Weymouth 745-5778 or Keshia Flint 735-6677*

We will be having four children's games one for each day of the fair. These games will include:

**Frisbee Toss** - Thursday, August 22<sup>nd</sup> at 3:00 PM behind the Ice Cream Parlor.

**Relay Race** - Friday, August 23<sup>rd</sup> at 3:00 PM behind the Ice Cream Parlor.

**Three-Legged Race** - Saturday, August 24<sup>th</sup> at 4:30 PM behind the Ice Cream Parlor.



## MISS MAPLE PAGEANT

*Keshia Flint 735-6677 or Danielle Hurd 991-1290*

**Saturday, August 24<sup>th</sup> at 10 AM on the stage**

Participants need to arrive at 9:30AM.

**Participants will be divided into grade levels:**

K-4th Grade is first class, 5th-8th Grade is second class, and 9th-12th Grade is third class.

Registration forms are available at [piscataquisvalleyfair.com](http://piscataquisvalleyfair.com). **All registration forms and music must be turned in by Monday, August 21<sup>st</sup> to participate.**

**There will be 3 categories for each class in this order:**

**Agricultural Wear/Country Wear-** Put on your best idea of what country/farm girls would wear.

**Talent-** Can be anything from singing and dancing to tying a knot.

**Formal Wear/Dress-up-** Does not have to be full formal it can be any type of dressy clothes.

Prizes: 1st place prize- Crown, Sash, and \$50.00 / 2nd place prize- \$25.00

Also, the 1st place winner of the 9th-12th grade class will also receive a \$200 scholarship.

**Event sponsored by:** Bob's Sugarhouse, The Bear's Den Restaurant, Motel, and Tavern, and Guilford Service Center.

## **POWER WHEELS DEMOLITION DERBY**

*Jasmane Hanson 207-735-6045*

**Sunday, August 25<sup>th</sup> during the Demo Derby**

Children ages 3-8 and 30 lbs-70 lbs (must be able to reach the pedals). Bicycle helmets are required for each child participating. The fair has vehicles and helmets available. Anyone interested must sign up Sunday on at the fair office. Each sign up will be placed in a "round". Children will meet the volunteers by the entrance to the track once their name is called. **NO PARENTS ON THE TRACK.** This is a non-profit event for the fair. ALL proceeds are donated to a children's program/event in the community.

## MAP & KEY OF FAIRGROUNDS

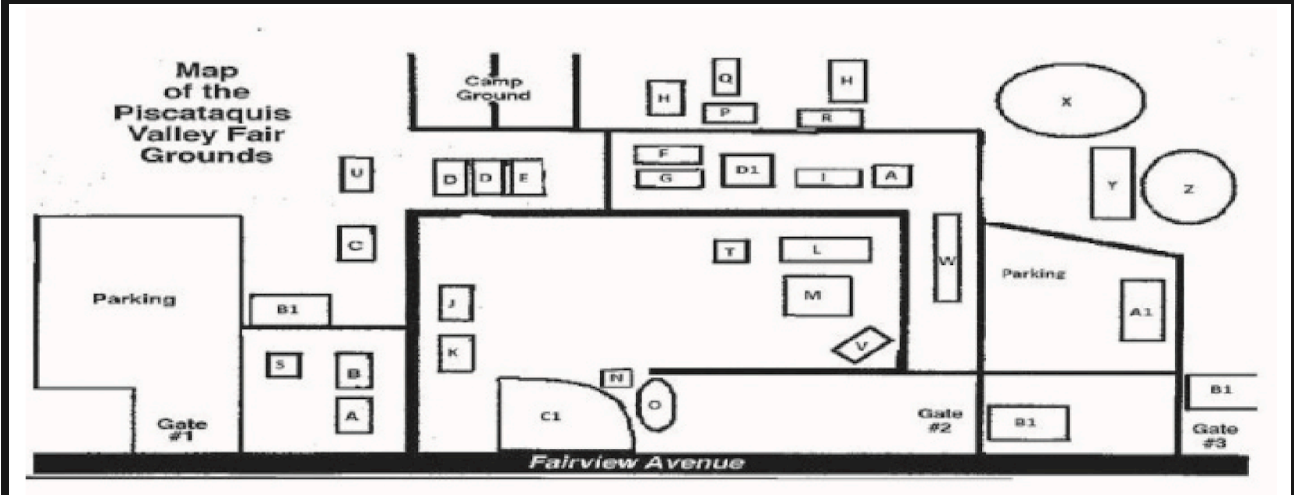

### Fairview Avenue

- |                    |                        |                        |                      |
|--------------------|------------------------|------------------------|----------------------|
| A. Rest Room       | I. Vendor Barn         | Q. Livestock Show Ring | Y. Mechanical Track  |
| B. Dining Hall     | J. DFFD Food Booth     | R. Ice Cream Parlor    | Z. Demo Derby Area   |
| C. First Aid       | K. Bingo Hall          | S. Vacant Booth        | A1. Draft Horse Barn |
| D. Exhibition Hall | L. PVFA Food Booth     | T. Bob's Sugarhouse    | B1. Ticket Booth     |
| E. 4-H Building    | M. Sheriff/Fair Office | U. DFFD Museum         | C1. Ball Field       |
| F. Animal Land     | N. Hockey Booth        | V. Stage               | D1. Play Area/Gazebo |
| G. Sheep Barn      | O. Hockey Rink         | W. Horse Pulling Ring  |                      |
| H. Cattle Barn     | P. Milking Parlor      | X. Horse Show Ring     |                      |

More Information available on the web:

[www.PiscataquisValleyFair.com](http://www.PiscataquisValleyFair.com)

Or find us on Facebook