

**MAP OF FAIRGROUNDS**

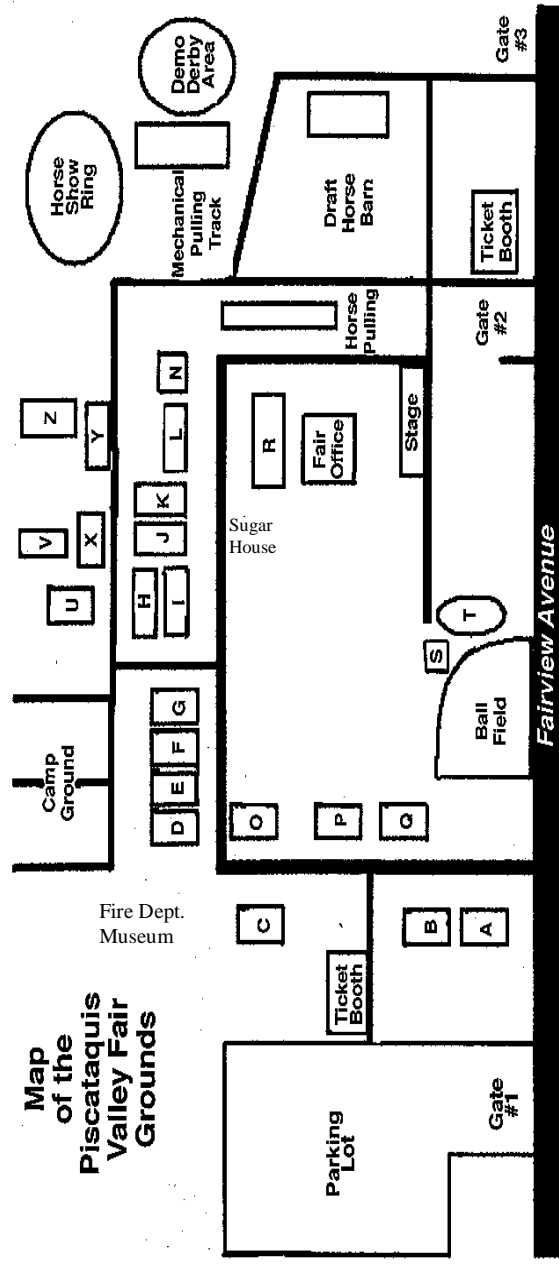

**No Pets Are Allowed on the Fairgrounds Except Service Dogs**

A: Rest Room  
 B: Dining Hall  
 C: Police & First Aid  
 D: Exhibition Hall  
 E: Exhibition Hall  
 F: Animal Land  
 G: 4-H / Flower Show  
 H: Sheep Barn  
 I: Sheep Barn  
 J: Cattle Barn  
 K: Cattle Barn  
 L: Goat Barn

N: Rest Room  
 O: 4-H Food Booth  
 P: Food Booth  
 Q: Bingo Hall  
 R: Fair Food Booth  
 S: Hockey Booth

T: Hockey Rink  
 U: Cattle Barn  
 V: Show Rink  
 X: Milking Parlor  
 Y: Ice Cream Parlor  
 Z: Cattle Barn

Map by: Megan Taylor

**Fair Food Booth**

(On the hill, overlooking the pulling area)

**Breakfast**

6 am to 11 am  
 Coffee, Juice, full breakfast - eggs, bacon, sausage, home fries.

**Lunch & Later:**

Burgers, hotdogs, sausage, fries, homemade pies, Water, Soda, and more.

**Fair Ice Cream Parlor**

(Beside the Milking Parlor)

Gifford's Ice Cream. Cones, Shakes, Floats, Sundaes, Lots of flavors. Pail of Creatures. Water & Soda.

**Chicken Barbeque**

Sunday:  
 Starts at 11:30am

(At the Dining Hall near Gate 1 ticket booth)  
 Chicken, bean hole beans, corn on the cob, coleslaw, roll, beverage.

**The Piscataquis Valley Fair thanks all those who make this fun filled event possible, including our advertisers, donors, sponsors, and volunteers.**

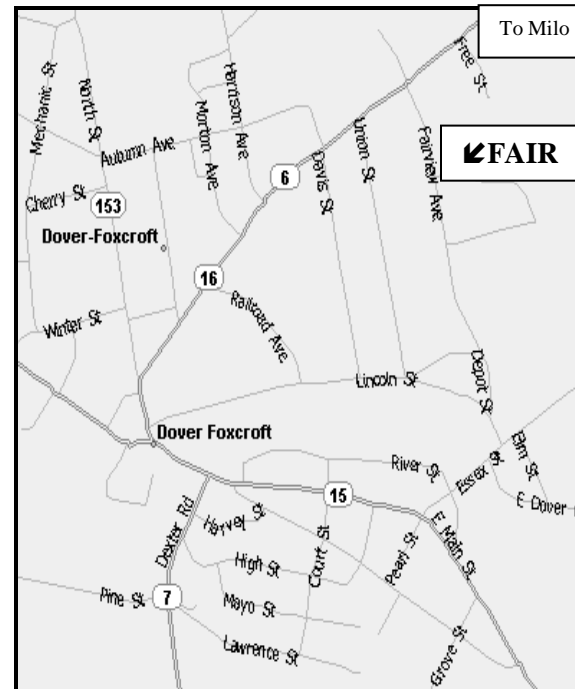

**Piscataquis Valley Fair Grounds**  
 Fair Office Tel 564-3689 Week of fair only  
 77 Fairview Ave., P O Box 197  
 Dover-Foxcroft, ME 04426



**Schedule of Events 2011**

**Thursday Aug. 25 thru Sunday Aug. 28**

**Thurs/Friday - Midway Opens 2 PM**  
**Sat/Sunday - Midway Opens 11 AM**  
**Fairgrounds Open at 6:00 AM**

**Admission:** \$6 Thurs, Fri, Sat, and Sun.  
 Children 5 to 10 years - \$2, Under 5 Free  
 Senior Citizens Day-Friday, Aug.26 - \$3

**Midway - Smokey's Greater Shows**  
 Wrist Band Days - All 4 days  
 (Does not include general admission)

Free Parking on the Grounds

**NO DOGS ALLOWED ON FAIRGROUNDS**  
 (EXCEPT SERVICE DOGS)

Events and times subject to change without notice  
 Not responsible for typographical errors

**More Information available on the web:**  
[www.PiscataquisValleyFair.com](http://www.PiscataquisValleyFair.com)

## 2011 Schedule August 25 thru August 28

### Thursday, August 25

Daily Antique Farm Equipment Display behind cattle barn (Z)

10:00 AM Open Flower Judging

12:00 Noon Animal Land Opens

12:00 Noon Exhibition Halls Open

12:00 Noon Fire Dept. Museum open until 8 pm

2:00 P.M. Midway Rides Open

4:00 P.M. Bingo

4:00 P.M. Pedal Tractor Pull at Milking Parlor

5:00 P.M. Car Show and Cruise In/Swap Meet in Mechanical Track area

5:30 P.M. Bicycle Drawing in front of Fair Office

6:00 P.M. Milking Demonstration at Parlor

6:00 P.M. Figure 8 - Mechanical track

7:00 P.M. Doughty Hill – on stage

8:15 P.M. He-Man Contest - Horse pulling area

9:00 P.M. Fireworks (south side of Fair Grounds)

### Friday, August 26

Daily Antique Farm Equipment Display behind cattle barn (Z)

10:00 A.M. Farm Horse Events at Pulling Area

10:00 A.M. Open Sheep Show

11:00 A.M. Youth Dairy Show

12:00 Noon Animal Land Opens

12:00 Noon Bingo

12:00 Noon Exhibition Halls Open

12:00 Noon Fire Dept. Museum open until 8 pm

12:30 P.M. Magic Show on hill by office

1:00 P.M. José – on stage

2:00 P.M. Midway Rides Open

2:00 P.M. Dan Grady's Marionette Show on the hill by office

3:30 P.M. Balloon Show on hill by office

5:00 P.M. Pedal Tractor Pull at Milking Parlor

5:30 P.M. Bicycle Drawing in front of Fair Office

6:00 P.M. Milking Demonstration at Parlor

6:00 P.M. Tuff Truck at Mechanical Track

6:00 P.M. Dan Grady's Marionette Show on the hill by office

8:00 P.M. Prospect Hill – on stage

### Saturday, August 27

Daily Antique Farm Equipment Display behind cattle barn (Z)

8:30 A.M. Equitation Horse Show at horse ring

9:00 A.M. Lawn and Garden Tractor Pulls

10:00 A.M. Animal Land Opens

10:00 A.M. Antique Auto Display after parade on ball field

10:00 A.M. Exhibition Halls Open

10:00 A.M. Fire Dept. Museum open until 8 pm

10:00 A.M. Horse Pulling

10:00 A.M. Cookie Decorating for kids – near the stage

10:00 A.M. Youth Beef Cattle Show

TBA Animal Costume Parade

11:00 A.M. Midway Rides Open

11:30 Noon Skillet Throw at Horse Pulling Area Sign up in Fair Office

12:00 Noon Pedal Tractor Pull at Milking Parlor

12:00 Noon Bingo

12:00 Noon Dan Grady's Marionette Show on the hill by office

1:00 P.M. Frog Jumping Contest-Ball Field

2:00 P.M. ATV Mud Runs at Mechanical track

2:00 P.M. Magic Show on hill by office

3:00 P.M. Dan Grady's Marionette Show on the hill by office

4:00 P.M. Bicycle Drawing in front of Fair Office

5:00 P.M. Don Campbell Band on stage

6:00 P.M. Milking Demonstration at Parlor

6:00 P.M. Balloon Show on hill by office

6:00 P.M. Truck Pulls – Mechanical Track

6:00 P.M. Wrist Wrestling –signup 5:30pm by Police building

8:00 P.M. Don Campbell Band on stage

### Sunday, August 28

Daily Antique Farm Equipment Display behind cattle barn (Z)

9:00 A.M. Game Horse Show - horse show ring

9:30 A.M. Horse Pulling

9:30 A.M. Youth Dairy Goat Show

10:00 A.M. Animal Land Opens

10:00 A.M. Doodlebug Draw – Mech. Track

10:00 A.M. Exhibition Halls Open

10:00 A.M. Fire Dept. Museum open until 8 pm

10:00 A.M. Pedal Tractor Pull at Milking Parlor

### Sunday, August 28 (continued)

10 to Noon Sign up for Pig Scramble at Fair Office, \$1 entry fee-Parent Permissn.

10:30 A.M. Pie Judging – Exhibition Hall #1

11:00 A.M. Midway Rides Open

11:00 A.M. New Realm – on stage

11:30 A.M. Chicken Barbeque at the Dining Hall near Gate 1 ticket booth

12:00 Noon Bingo

12:00 Noon Dan Grady's Marionette Show on the hill by office

12:00 Noon Pedal Tractor Pull Off - at Milking Parlor

1:00 P.M. Pig Scramble at Horse Pulling Area Sign up 10-12 at Office, \$1 fee, PP

2:00 P.M. Magic Show on hill by office

2:00 P.M. Demolition Derby – Mech. Track

3:00 P.M. Dan Grady's Marionette Show on the hill by office

4:00 P.M. Bicycle Drawing in front of Fair Office

4:10 P.M. Balloon Show on hill by office

### Entertainment

**Fireworks** – Thursday 9:00 PM

**Balloon Shows:** Friday – 3:30 PM  
Saturday – 6:00 PM, Sunday – 4:10 PM

**Banjo Man** (Ron Coates)  
Strolling – Saturday & Sunday

**Magic Shows:** Friday – 12:30 PM  
Saturday – 2:00 PM, Sunday – 2:00 PM

**Dan Grady's Marionette Shows**  
Friday – 2:00 and 6:00 PM  
Saturday – 12:00 Noon and 3:00 PM  
Sunday – 12:00 Noon and 3:00 PM

### Music

**Doughty Hill – Thursday 7:00 PM**

**José – Friday 1:00 PM**

**Prospect Hill – Friday 8:00 PM**

**Don Campbell Band – Sat. 5:00 & 8:00 PM**

**New Realm – Sunday 11:00 AM**

**More Information available on the web:**

**[www.PiscataquisValleyFair.com](http://www.PiscataquisValleyFair.com)**

**Dining Hall Rental** – during the year  
Deanne Merrill.....Tel.943-2650

**Grounds Rental / Vendor Space** - during Fair  
Contact – Betty Jo Cuthbertson  
Vendor Coordinator 564-8330 or 717-3196

**Camping on Grounds** - during the Fair  
To Pre-register Contact: Trey Cuthbertson,  
Camping Supt. at 564-8330 or 717-3197.  
\$20 per day charge for camping plus \$6.00 per person per day Admission. Payment will be required prior to set up. Power limit: 19 amps.

**Information and Hours to Enter Exhibits**  
***PLEASE Do Not Submit Items If You Are Unable To Pick Them Up By 6:00 pm Sunday***

**Flower Show:** 4-H Hall  
Terry Ogden.....Tel. 564-3963  
Wednesday evening Aug. 24, 4 pm to 8 pm.

**Food & Produce:** Exhibition Hall #1  
Michelle Hodges .....Tel 285-1032  
Wednesday, Aug.24, 4 pm to 8 pm

**Home Arts & Crafts:** Exhibition Hall #1  
Nan Redmond.....Tel. 564-3088  
Tuesday, Aug. 23, 2 pm to 7 pm

---

**4-H Exhibits:** Contact: Brenda Mowdy  
Tel. 327-2111 or 1-800-287-1491

**Equitation Horse Show:** Foxcroft Pony Club  
Contact: Kim Shaffer ..... Tel. 943-2173  
Contact: Wayne Doane..... Tel. 379-2068

**Family Game Show:** Amanda Sherburne  
Contact: [www.dexterridingclub.com](http://www.dexterridingclub.com)

**Farm Horse Events:** Ken Johnson,  
Superintendent.....Tel. 876-3204

**Horse Pulling:** Karna Johnson,  
Superintendent.....Tel. 343-4355

**Livestock:** Ron Simpson, Superintendent  
Contact .....Tel. 270-1212

**Central ME Sheep Breeders:**  
Contact: Chad Perkins.....Tel. 965-2388

**Sheep Show:** Billy Webster ....Tel.831-0608

**Mechanical Track:**  
Dan Bishop.....Tel. 564-7700