

Flower Show, Food & Produce, and Home Arts/Crafts – Additional information can be found on the Fair website.

Information and Hours to Enter Exhibits
PLEASE Do Not Submit Items If You Are Unable To Pick Them Up By 6:00 pm Sunday

Flower Show: 4-H Hall
 Terry Ogden..... Tel. 564-3963
 Wednesday evening Aug. 25, 4 pm to 8 pm.

Food & Produce: Exhibition Hall #1
 New food events- details also on web site
 Michelle Hodges Tel 285-1032
 Wednesday, Aug.25, 4 pm to 8 pm

Home Arts & Crafts: Dining Hall, Gate #1
 Nan Redmond Tel. 564-3088
 Tuesday, Aug. 24, 2 pm to 7 pm

4-H Exhibits: Tel.564-3301
Equitation Horse Show: Foxcroft Pony Club
 Contact: Kim Shaffer..... Tel. 343-0033

Game Horse Show: Amanda Sherburne
 Contact Tel. 277-5029

Farm Horse Events: Ken Johnson,
 Superintendent Tel. 876-3204

Horse Pulling: Donald Merrill,
 Superintendent Tel. 943-2650

Livestock: Tonya Patten, Superintendent
 Contact Tel. 343-2007

Central ME Sheep Breeders:
 Contact: Chad Perkins Tel. 965-2388

Youth Sheep Show:
 Contact: Billy Webster. Tel. 831-0608

Horseshoe Tournament: Theresa Hughes or
 David Poissionnier Tel.564-5125

Mechanical Track:
 Dan Bishop Tel. 564-7700
 Billy Smart..... Tel. 564-7712

Grounds Rental: Contact – Rob Ricker
 Vendor Coordinator Tel. 943-7454

More Information available on the web:
www.PiscataquisValleyFair.com



**The Piscataquis Valley
 Fair thanks all those
 who make this fun
 filled event possible,
 including our
 advertisers, donors,
 sponsors, and
 volunteers.**

Schedule of Events 2010

**Thursday Aug. 26 thru
 Sunday Aug. 29**

77 Fairview Ave., P O Box 197
 Dover-Foxcroft, ME 04426
 Telephone 564-3689 Week of Fair Only
www.PiscataquisValleyFair.com

**Thurs/Friday - Midway Opens 2 PM
 Sat/Sunday - Midway Opens 11 AM
 Fairgrounds Open at 6:00 AM**

Admission: \$6 Thurs, Fri, Sat, and Sun.
 Children 5 to 10 years - \$2, Under 5 Free
 Senior Citizens Day–Friday, Aug.27 - \$3

Wrist Band Days – All 4 days
 (Does not include general admission)

Free Parking on the Grounds
**NO DOGS ALLOWED ON FAIRGROUNDS
 (EXCEPT SERVICE DOGS)**

Events and times subject to change without notice
 Not responsible for typographical errors

Midway

Smokey's Greater Shows

Entertainment

**Fireworks – Thursday 9:00 PM
 Balloon Shows / Magic Shows
 Friday-Saturday-Sunday-See Schedule**

Music

**Deja Blue Band – Thursday 7:30 PM
 Civil Disturbance Band – Friday 8:30 PM
 Rhoads Band – Saturday 4:00 PM
 Midnight Rose Band – Saturday 6:30 PM
 Roy Hudson Band – Saturday 8:00 PM**

Camping on Grounds

To Pre-register Contact Gary Sudsbury at
 564-2931, 343-4389 or suds43@myfairpoint.net
 OR Betty-Jo Cuthbertson at 717-3196.
 \$20 per day charge for camping plus \$6.00 per
 person per day Admission. Payment will be
 required prior to set up. Power limit: 19 amps.

2010 Schedule August 26 thru August 29

Thursday, August 26

- 12 – 8 P.M. Fire Dept Museum by Police Bldg
- 12:00 Noon Exhibition Halls Open
- 12:00 Noon Animal Land Opens
- 2:00 P.M. Midway Rides Open
- 4:00 P.M. Pedal Tractor Pull at Milking Parlor
- 5:00 P.M. Milking Demonstration at Parlor
- 5:00 P.M. Car Show and Cruise In
- 5:30 P.M. Bicycle Drawing-Fair Office
- 6:00 P.M. Figure 8 - Mechanical track
- 7:30 P.M. Deja Blue Band at stage
- 8:15 P.M. He-Man Contest - Horse pulling area
- 9:00 P.M. Fireworks

Friday, August 27

- 9:00 A.M. Farm Horse Events at Pulling Area
- 10:00 A.M. Youth Sheep Show
- 10:00 A.M. Youth Dairy Show
- 12 – 8 P.M. Fire Dept Museum by Police Bldg
- 12:00 Noon Exhibition Halls Open
- 12:00 Noon Animal Land Opens
- 12:00 Noon Bingo
- 12-1 P M Sample Sheep Products
- 12:30 P.M. Magic Show on hill by office
- 2:00 P.M. Midway Rides Open
- 3:30 P.M. Balloon Show on hill by office
- 5:00 P.M. Pedal Tractor Pull at Milking Parlor
- 5:00 P.M. Milking Demonstration at Parlor
- 5:30 P.M. Bicycle Drawing-Fair Office
- 6:00 P.M. Tuff Truck at Mechanical Track
- 8:30 P.M. Civil Disturbance Band at stage

Saturday, August 28

- 8:30 A.M. Equitation Horse Show at horse ring
- 9:00 A.M. ATV & Lawn/Garden Tractor Pulls
- 10:00 A.M. Antique Auto Display
- 10-12 Noon. Kids Cookie Decorating-Dining Hall
Fair provides cookies/ deco. supplies
- 10:00 A.M. Exhibition Halls Open
- 10:00 A.M. Animal Land Opens
- 10 – 8 P.M. Fire Dept Museum by Police Bldg
- 10:00 A.M. Horse Pulling
- 10:00 A.M. Horseshoe Tournament at
hockey rink (signup 9:30)
- 10:00 A.M. Youth Beef Cattle Show
- 10:00 A.M. Karaoke at stage

Saturday, August 28 (continued)

- TBA Animal Costume Parade
- TBA Animal Obstacle Course
- 11:00 A.M. Midway Rides Open
- 11:30 Noon Skillet Throw at Horse Pulling Area
- 12:00 Noon Pedal Tractor Pull at Milking Parlor
- 12:00 Noon Bingo
- 12-1 P M Sample Sheep Products
- 1:00 P.M. ATV Obstacle Course-Mech.Track
- 1:00 P.M. Frog Jumping Contest-Ball Field
- 2:00 P.M. Magic Show on hill by office
- 2:00 P.M. ATV Mud Runs at Mechanical track
- 4:00 P.M. Bicycle Drawing at Fair Office
- 4:00 P.M. Rhoads Band at stage
- 5:00 P.M. Milking Demonstration at Parlor
- 6:00 P.M. Balloon Show on hill by office
- 6:00 P M Street Truck Pulls-Mechanical track
by Police building
- 6:00 P.M. Wrist Wrestling –signup 5:30pm
- 6:30 P.M. Midnight Rose Band at stage
- 8:00 P.M. Roy Hudson Band at stage

Sunday, August 29

- 9:00 A.M. Game Horse Show - horse show ring
- 9:30 A.M. Horse Pulling
- 9:30 A.M. Youth Dairy Goat Show
- 10:00 A.M. Exhibition Halls Open
- 10:00 A.M. Animal Land Opens
- 10 – 8 P.M. Fire Dept Museum by Police Bldg
- 10:00 A.M. Doodlebug Draw – Mech. Track
- 10-12 Noon Sign up for Pig Scramble at Fair
Office, \$1 entry fee-Parent Permissn.
- 10:00 A.M. Pedal Tractor Pull at Milking Parlor
- 10:00 A.M. Horseshoe Tournament at
hockey rink (signup 9:30)
- 10:30 A.M. Pie Judging – Exhibition Hall #1
- 11:00 A.M. Chicken Barbeque on hill by office
- 11:00 A.M. Fishers of Men – music at stage
- 11:00 A.M. Midway Rides Opens
- 12:00 Noon Bingo
- 1:00 P.M. Pig Scramble at Horse Pulling Area
Sign up 10-12 at Office, \$1 fee, PP
- 1:30 P.M. Magic Show on hill by office
- 2:00 P.M. Demolition Derby – Mech. Track
- 3:00 P.M. Pedal Tractor Pull-Off moves to
Mechanical Track
- 4:00 P.M. Bicycle Drawing –Fair Office
- 4:15 PM Balloon Show on hill by office

MAP OF FAIRGROUNDS

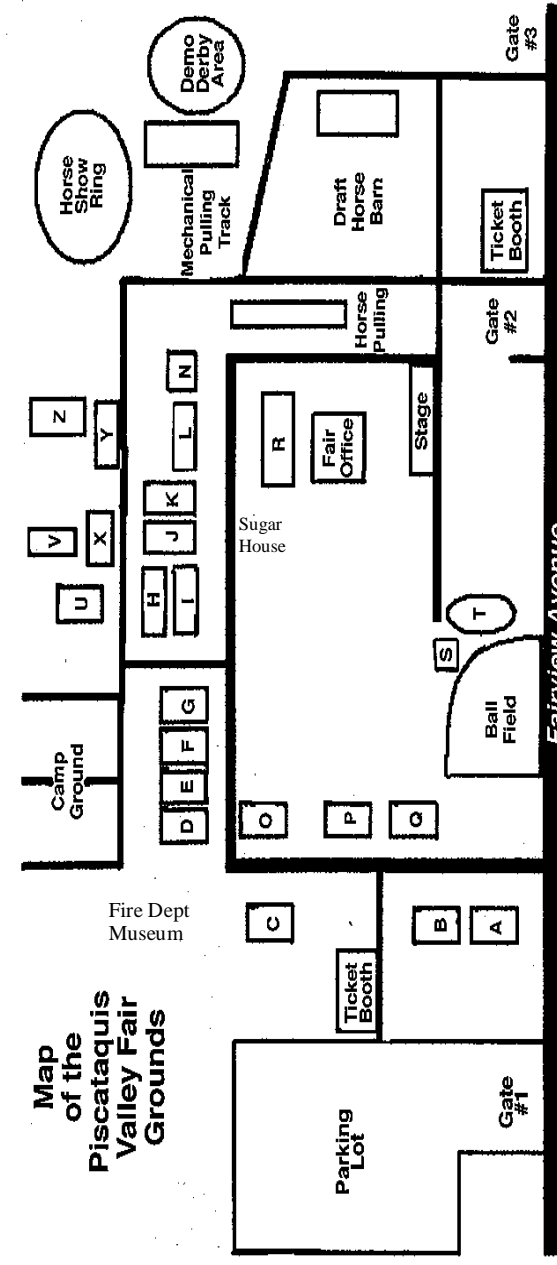

**No Pets Are Allowed on The
Fairgrounds Except Service Dogs**

<p>A: Rest Room B: Dining Hall C: Police & First Aid D: Exhibition Hall E: Exhibition Hall F: Animal Land</p>	<p>G: 4-H / Flower Show H: Sheep Barn I: Sheep Barn J: Cattle Barn K: Cattle Barn L: Goat Barn</p>	<p>N: Rest Room O: 4-H Food Booth P: Food Booth Q: Bingo Hall R: Fair Food Booth S: Hockey Booth</p>	<p>T: Hockey Rink U: Cattle Barn V: Show Rink X: Milking Parlor Y: Ice Cream Parlor Z: Cattle Barn</p> <p style="text-align: right; font-size: small;"><i>Map by: Megan Taylor</i></p>
<p>Fair Food Booth</p> <p>(On the hill, overlooking the pulling area)</p> <p>Breakfast 6 am to 11 am Coffee, Juice, full breakfast - eggs, bacon, sausage, home fries.</p> <p>Lunch & Later: Burgers, hotdogs, sausage, fries, homemade pies, Water, Soda, and more.</p>			
<p>Fair Ice Cream Parlor</p> <p>(Beside the Milking Parlor)</p> <p>Gifford's Ice Cream. Cones, Shakes, Floats, Sundaes, Lots of flavors. Pail of Creatures. Water & Soda.</p>			
<p>Chicken Barbeque</p> <p>Sunday: Starts at 11am (On the hill, beside the Fair Food Booth) Chicken, bean hole beans, corn on the cob, coleslaw, roll, beverage.</p>			