

Midway

Smokey's Greater Shows

Entertainment

Fireworks – Thursday 9:00 PM

Balloon Shows / Magic Shows

Friday-Saturday-Sunday-See Schedule

Music

Dave Mallett – Thursday 7:00 PM

Dead Season – Friday 8:30 PM

Roy Hudson Band – Sat. 7:30 PM

Deja Blue – Saturday 7:30 PM

Camping on Grounds

To Pre-register Contact Gary Sudsbury at 564-2931, 343-4389 or suds43@myfairpoint.net \$20 per day charge for camping plus \$6.00 per person per day Admission. Payment will be required prior to set up. Power limit: 29 amps.

Grounds Rental Contact Rob Ricker 943-7454

Flower Show, Food & Produce, and Home

Arts/Crafts – This year's competitions have been updated. The structure and premiums have been modified to be closer to competitions at other Fairs. The Fair Flyer now provides contact information for competitions. Additional information can be found on the Fair website.

Information and Hours to Enter Exhibits

PLEASE Do Not Submit Items If You Are Unable To Pick Them Up By 6:00 pm Sunday

Flower Show: 4-H Hall

Terry Ogden.....Tel. 564-3963

Wednesday evening Aug. 26, 4 pm to 8 pm.

Food & Produce: Exhibition Hall #1

New food events- details also on web site

Terry Ogden.....Tel 564-3963

Wednesday, Aug.26, 4 pm to 8 pm

Home Arts & Crafts: Exhibition Hall #1

Deanne Merrill.....Tel. 943-2650

Tuesday, Aug. 25, 2 pm to 7 pm

4-H Exhibits: Linda Whitten.....Tel.564-3301

Barrel Horse Racing: Christina Waters

Contact.....Tel. 379-2027

Equitation Horse Show: Angela Coy

Email: angie@infinityfarm.us or Tel. 343-0033

Farm Horse Events: Ken Johnson,

SuperintendentTel. 876-3204

Horse Pulling: Stewart Hopkins,

SuperintendentTel. 277-4281

Livestock: Tonya Patten, Superintendent

ContactTel. 564-3900

Central ME Sheep Breeders:

Contact: Chad Perkins.....Tel. 965-2388

Youth Sheep Show:

Contact: Billy Webster.....Tel. 831-0608

Horseshoe Tournament: Theresa Hughes or

David Poissonnier..... Tel.564-5125

Mechanical Track: Rusty Weymouth,

SuperintendentTel. 285-3192

More Information available on the web:

www.PiscataquisValleyFair.com

SPONSORS

The Piscataquis Valley Fair thanks all those who make this fun filled event possible, including our advertisers and donors: (Full page & half page advertisers)

Camden National Bank, Crnth, D-F, Grvl. Milo

Dorr's Equipment, Bangor

Dover True Value, Dover-Foxcroft

Merl "Sam" Dunham Waterwells, Corinth

Northwood Power Equipment, Hermon

P & L Country Market, Dexter

PEPSI

A E Robinson Oil Co, Dover-Foxcroft

Skowhegan Savings Bank

Bailey Lumber Company, Milo

Bennett Construction, Parkman

Blackwell Insurance Agency, Corinth & Dexter

Dexter Variety, Dexter

Evergreen Auto & Salvage, Sebec

Haley Construction, Sangerville

H A Higgins & Sons, Charleston

Mayo Regional Hospital, Dover-Foxcroft

Sponsor of First Aid Station

Milo Farmers Union, Milo

Rowe's Garage & Auto Sales, Corinth

Snow's Saw Shop, Atkinson

R A Thomas Logging, Guilford

Tradewinds Marketplace, Corinth

Trask Insurance, Milo

Webber Hardware, Dover-Foxcroft

Windsong Farms Transport, Levant

DONORS

Town of Dover-Foxcroft

Earl Gerrish & Sons, Brownville

Johnson Foundations, Dover-Foxcroft

Johnson's Water Proofing Systems

Maine Community Foundation (stage grant)

Northscape Earthworks, Dover-Foxcroft

Dean Rideout & Sons Trucking, D-F

Tilton Auction, Corinth

WCL Carpentry: Will Robinson, Atkinson



**Program of Events
2009**

**Thursday Aug. 27 Thru
Sunday Aug. 30**

77 Fairview Ave., P O Box 197

Dover-Foxcroft, ME 04426

Telephone 564-3689 Week of Fair Only

www.PiscataquisValleyFair.com

**Thurs/Friday - Midway Opens 2 PM
Sat/Sunday - Midway Opens 11 AM
Fairgrounds Open at 6:00 AM**

Admission: \$6 Thurs, Fri, Sat, and Sun.
Children 5 to 10 years - \$2, Under 5 Free
Senior Citizens Day–Friday, Aug.28 - \$3

**Wrist Band Days – All 4 days
(Does not include general admission)**

Free Parking on the Grounds

**NO DOGS ALLOWED ON FAIRGROUNDS
(EXCEPT SERVICE DOGS)**

Events and times subject to change without notice
Not responsible for typographical errors

2009 Program August 27 thru August 30

Thursday, August 27

- 10:00 A.M. Open Flower Judging
- 12:00 Noon Fire Department Museum next to Police building-open until 8pm
- 12:00 Noon Exhibition Halls Open
- 12:00 Noon Animal Land Opens
- 2:00 P.M. Midway Rides Open
- 4:00 P.M. Pedal Tractor Pull at Milking Parlor
- 5:00 P.M. Milking Demonstration at Parlor
- 5:30 P.M. Bicycle Drawing-Fair Office
- 6:00 P.M. Figure 8 - Mechanical track
- 7:00 P.M. Dave Mallett (at stage)
- 8:15 P.M. He-Man Contest - Horse pulling area
- 9:00 P.M. Fireworks

Friday, August 28

- 9:00 A.M. Farm Horse Events at Pulling Area
- 10:00 A.M. Youth Sheep Show
- 10:00 A.M. Youth Dairy Show
- 12:00 Noon Fire Department Museum next to Police building-open until 8pm
- 12:00 Noon Exhibition Halls Open
- 12:00 Noon Animal Land Opens
- 12:00 Noon Bingo
- 12-1 P M Sample Sheep Products
- 12:30 P.M. Magic Show on hill by office
- 2:00 P.M. Midway Rides Open
- 3:30 P.M. Balloon Show on hill by office
- 5:00 P.M. Pedal Tractor Pull at Milking Parlor
- 5:00 P.M. Milking Demonstration at Parlor
- 5:30 P.M. Bicycle Drawing-Fair Office
- 6:00 P.M. Tuff Truck at Mechanical Track
- 8:30 P.M. Dead Season (at stage)

Saturday, August 29

- 8:30 A.M. Equitation Horse Show
- 10:00 A.M. Antique Auto Display
- 10-12 Noon. Kids Cookie Decorating-Dining Hall Fair provides cookies/ deco. supplies
- 10:00 A.M. Exhibition Halls Open
- 10:00 A.M. Animal Land Opens
- 10:00 A.M. Fire Department Museum next to Police building-open until 8pm
- 10:00 A.M. Horse Pulling
- 10:00 A.M. ATV Obstacle Course

Saturday, August 29 (continued)

- 10:00 A.M. Youth Beef Cattle Show
- 10:00 A.M. Horseshoe Tournament at hockey rink (signup 9:30)
- TBA Animal Costume Parade
- TBA Animal Obstacle Course
- 11:00 A.M. Midway Rides Open
- 11:30 Noon Skillet Throw at Horse Pulling Area
- 12:00 Noon Pedal Tractor Pull at Milking Parlor
- 12:00 Noon Bingo
- 12:00 Noon ATV / Garden Tractor Pulls
- 12-1 P M Sample Sheep Products
- 1:00 P.M. Frog Jumping Contest-Ball Field
- 2:00 P.M. Magic Show on hill by office
- 4:00 P.M. Bicycle Drawing at Fair Office
- 5:00 P.M. Milking Demonstration at Parlor
- 6:00 P.M. Balloon Show on hill by office
- 6:00 P M Truck Pulls at Mechanical track
- 6:00 P.M. Wrist Wrestling -signup 5:30pm by Police building
- 7:30 P.M. Roy Hudson Band and Deja Blue (at stage)

Sunday, August 30

- 9:00 A.M. Barrel Horse Racing
- 9:00 A.M. Doodlebug Draw
- 9:30 A.M. Horse Pulling
- 9:30 A.M. Youth Dairy Goat Show
- 10:00 A.M. Exhibition Halls Open
- 10:00 A.M. Animal Land Opens
- 10:00 A.M. Fire Department Museum next to Police building-open until 8pm
- 10-12 Noon Sign up for Pig Scramble at Fair Office, \$1 entry fee-Parent Permissn.
- 10:00 A.M. Pedal Tractor Pull at Milking Parlor
- 10:00 A.M. Horseshoe Tournament at hockey rink (signup 9:30)
- 10:30 A.M. Pie Judging - Exhibition Hall #1
- 11:00 A.M. Chicken Barbeque on hill by office
- 11:00 A.M. Midway Rides Opens
- 12:00 Noon Pedal Tractor Pull-Off at milk parlor
- 12:00 Noon Bingo
- 1:00 P.M. Pig Scramble at Horse Pulling Area Sign up 10-12 at Office, \$1 fee, PP
- 1:30 P.M. Magic Show on hill by office
- 2:00 P.M. Demolition Derby
- 4:00 P.M. Bicycle Drawing -Fair Office
- 4:15 PM Balloon Show on hill by office

MAP OF FAIRGROUNDS

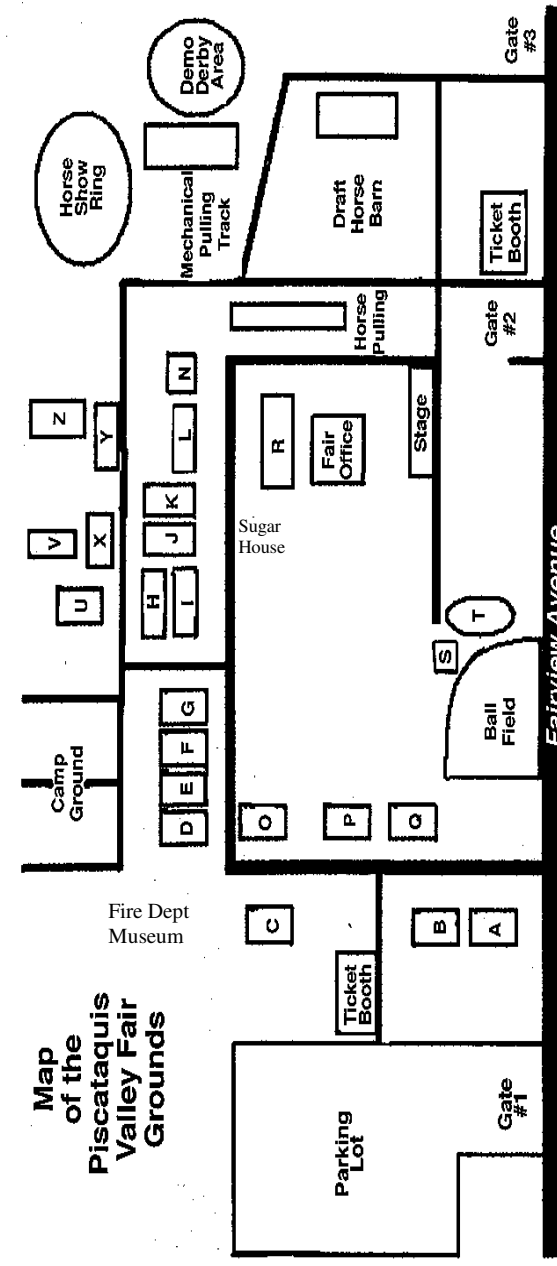

No Pets Are Allowed on The Fairgrounds Except Service Dogs

A: Rest Room B: Dining Hall C: Police & First Aid D: Exhibition Hall E: Exhibition Hall F: Animal Land	G: 4-H / Flower Show H: Sheep Barn I: Sheep Barn J: Cattle Barn K: Cattle Barn L: Goat Barn	N: Rest Room O: 4-H Food Booth P: Food Booth Q: Bingo Hall R: Fair Food Booth S: Hockey Booth	T: Hockey Rink U: Cattle Barn V: Show Rink X: Milking Parlor Y: Ice Cream Parlor Z: Cattle Barn
---	--	--	--

Map by: Megan Taylor

Fair Food Booth
 (On the hill, overlooking the pulling area)

Breakfast
 6 am to 11 am
 Coffee, Juice, full breakfast - eggs, bacon, sausage, home fries.

Lunch & Later:
 Burgers, hotdogs, sausage, fries, homemade pies, Water, Soda, and more.

Fair Ice Cream Parlor
 (Beside the Milking Parlor)

Gifford's Ice Cream. Cones, Shakes, Floats, Sundaes, Lots of flavors. Pail of Creatures. Water & Soda.

Chicken Barbeque
 Sunday:
 Starts at 11am
 (On the hill, beside the Fair Food Booth)
 Chicken, bean hole beans, corn on the cob, coleslaw, roll, beverage.